

## Load Turner - PalTurn™

### Product information



The principle of PalTurn™ is to turn all types of loads over in a space thanks to flat straps.

PalTurn™ is made up of a bar - rotated by a gear motor – driving the load via straps fitted onto encased drive pulleys. A control button box enables the functioning of the system.

To adapt PalTurn™ to different installations, there are several top hooks for single or double hook. The use of PalTurn™ does not require any anchoring point on the turned over load – the load is supported by the straps. Each device can turn over different types of loads, insofar as the capacity is adequate and the available straps have an adapted length.

The textile straps can be impregnated for regular loads with no sharp edges or can be coated for restrictive loads with sharp edges.

#### Options:

- The devices can be proposed with a wired control or a remote control.
- An imbalance system can be fitted to your Pal Turn™. It is designed to show the imbalanced position of the Pal Turn™ by a sound and/or light signal, i.e., to show that the Pal Turn™ has reached an inclination angle greater than 6° with respect to the horizontal plane.

Use group = FEMA5

[... Read more](#)

**Marking:** CE-marked, 2006/42/CE : Machinery directive. FEM 1.001 rev. 98.

**Finish:** Hot epoxy coating

# Load Turner - PalTurn™

## Blueprint

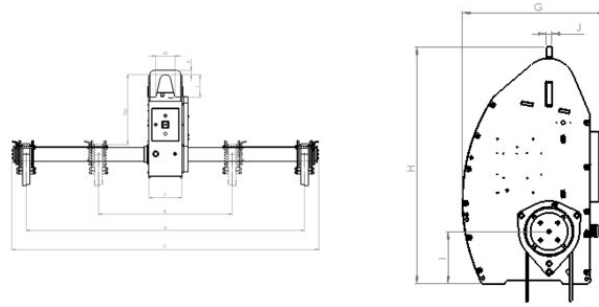

## Technical data

Part code	WLL (metric) tonnes	Type	Motor kW	Additional weight per 1 m lift	B in	C in	Ø D mm in	E in	F in	G, in	H, in	Hp in	I mm in	J in	K in	L in	M mm in	Weight lb
6297211978005	0.5	Single-phase	0.18	-	18.11	49.21	3.15	1.97	8.35	17.13	18.98	12.6	5.43	0.59	1.18	3.94	3.15	227.08
6297211968005	0.5	Three-phase	0.18	-	18.11	49.21	3.15	1.97	8.35	17.13	18.98	12.6	5.43	0.59	1.18	3.94	3.15	227.08
6297211978010	1	Single-phase	0.25	30	19.69	A+360	5.2	3.94	10.43	20.94	26.77	15.35	6.77	0.59	1.18	3.94	3.15	551.16
6297211968010	1	Three-phase	0.25	30	19.69	A+360	5.2	3.94	10.43	20.94	26.77	15.35	6.77	0.59	1.18	3.94	3.15	551.16
6297211978020	2	Single-phase	0.55	30	23.62	A+360	5.2	3.94	14.57	23.23	39.96	25.98	8.86	0.98	1.57	8.27	6.89	793.66
6297211968020	2	Three-phase	0.55	30	23.62	A+360	5.2	3.94	14.57	23.23	39.96	25.98	8.86	0.98	1.57	8.27	6.89	793.66
6297211978050	5	Single-phase	0.75	58	23.62	A+360	5.2	3.94	14.57	23.23	39.96	25.98	8.86	0.98	1.57	8.27	6.89	826.73
6297211968050	5	Three-phase	0.75	58	23.62	A+360	5.2	3.94	14.57	23.23	39.96	25.98	8.86	0.98	1.57	8.27	6.89	826.73
6297211978100	10	Single-phase	1.5	-	39.37	A+440	7.87	7.87	18.5	38.98	62.99	34.06	20.87	1.18	2.76	7.87	7.87	2,513.27
6297211968100	10	Three-phase	1.5	-	39.37	A+440	7.87	7.87	18.5	38.98	62.99	34.06	20.87	1.18	2.76	7.87	7.87	2,513.27
6297211978200	20	Single-phase	3	-	47.24	A+540	9.84	10.24	22.83	40.94	70.28	39.76	20.87	1.18	3.35	13.78	7.87	3,791.95
6297211968200	20	Three-phase	3	-	47.24	A+540	9.84	10.24	22.83	40.94	70.28	39.76	20.87	1.18	3.35	13.78	7.87	3,791.95