

Super Reeve Connector Swivel Sockets SCS-SW - with pin

Product information



- Dimensional tolerances depend on the manufacturing techniques applied and are different between machined components (pins) and cast components (socket bodies and wedges).
- All sockets are provided with an EN 10204-2.1 declaration of conformity, EN 10204-3.1 material certificate and can be provided with a 2006/42/EC declaration where applicable.
- Also surface finish e.g. hot dip galvanizing may add to the overall thickness and fork distance.

... [Read more](#)

Material: Quenched and tempered cast steel.

Finish: Hot dipped galvanized.

Super Reeve Connector Swivel Sockets SCS-SW - with pin

Blueprint

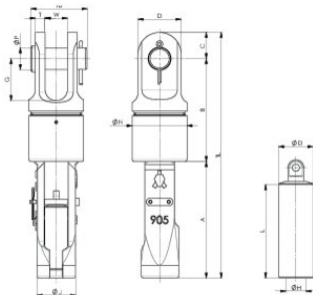

Technical data

Part code	Rope Ø range mm	MBL tonnes	Finish	A in	B in	C in	D, in	G, in	Nmm in	L in	T in	TBmm in	TLmm in	Ø D mm in	Ø Hmm in	Ø J mm in	Ø Pmm in	Wmm in	Weight lb
122101600272	13-16	25	Galvanized	7.17	6.18	1.26	2.28	2.36	2.99	3.86	0.55	3.35	14.61	1.26	0.75	2.2	1.18	1.26	15.43
122101900272	16-19	40	Galvanized	8.19	7.32	1.57	2.76	2.76	3.66	4.49	0.63	3.74	17.09	1.57	0.87	2.56	1.38	1.5	24.25
122102200272	20-22	55	Galvanized	9.37	8.19	1.77	3.15	3.15	4.13	5.12	0.75	4.33	19.33	1.73	1.02	3.03	1.61	1.73	37.48
122102600272	23-26	75	Galvanized	10.47	9.25	2.36	3.86	3.78	4.92	5.59	0.87	5.04	22.09	2.05	1.22	3.46	1.97	2.01	57.32
122102900272	27-29	90	Galvanized	11.42	10.31	2.56	4.25	4.21	5.31	6.26	0.98	5.59	24.29	2.28	1.34	3.78	2.24	2.24	74.96
122103200272	30-32	125	Galvanized	12.87	11.5	2.87	4.72	4.65	5.91	6.97	1.1	6.1	27.24	2.52	1.42	4.33	2.48	2.48	108.03