

Open Spelter Sockets JIS with bolt

Product information



Quenched and tempered cast steel range with mechanical values (Charpy-V > 42 Joule /-20°C) for tough and low temperature use. For wire rope diameter 6 - 203 mm (1/4" - 8").

- Pin securing by cotter pin or bolt securing by nut and cotter pin.
- Optional is a flange connection for use with a bend stiffener.
- All spelter sockets have a 100% efficiency.

... [Read more](#)

Material: Quenched and tempered cast steel

Marking: Size, wire rope diameter and batch or serial number.

Finish: Blue painted

Note: For intermediate rope diameter select fittings with nearest following size.

Warning: Compare the spelter's and the wire rope's minimum breaking load.

Open Spelter Sockets JIS with bolt

Blueprint

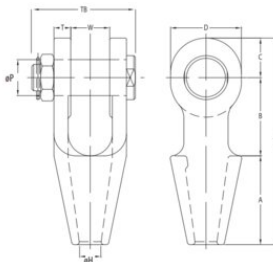

Technical data

Part code	Rope Ø range mm	MBL tonnes	Finish	A in	B in	C in	D, in	øH mm in	øP mm in	T in	TL mm in	TB mm in	Wmm in	Weight lb
122101900525	18-19	28	Painted	3.5	2.99	1.57	2.76	0.83	1.18	0.63	8.07	4.21	1.5	6.61
122102240525	20-22.4	35	Painted	3.98	3.5	1.77	3.15	0.94	1.34	0.75	9.25	4.84	1.73	9.7
122102600525	23-26	41	Painted	4.49	3.98	2.36	4.09	1.1	1.46	0.87	10.83	5.43	2.01	18.08
122102600526	23-26	52	Painted	4.49	3.98	2.36	4.09	1.1	1.57	0.87	10.83	5.43	2.01	18.08
122103000525	27-30	56	Painted	5	4.49	2.56	4.49	1.26	1.69	0.98	12.05	6.3	2.24	25.13
122103000526	27-30	69	Painted	5	4.49	2.56	4.49	1.26	1.81	0.98	12.05	6.3	2.24	25.57
122103600525	31-36	69	Painted	5.47	5	2.83	4.96	1.5	1.89	1.1	13.31	6.85	2.48	33.07
122103600526	31-36	88	Painted	5.47	5	2.83	4.96	1.5	2.05	1.1	13.31	6.85	2.48	33.51
122103900525	35.5-39	94	Painted	5.98	6.38	3.15	5.59	1.61	2.2	1.18	15.51	7.91	2.99	48.5