

Sheave with Cylindrical Roller Bearings, Rigging

Product information



Self-lubricating cast sheaves are often applied in lifting, luffing and wire rope routing with intensive operating cycles. The groove opening angle was carefully designed to reduce potential twist resulting from fleet angles. In combination with the self-lubricating effect, the wire rope in your system will last longer. The latter was proved in recent research, in which several sheave materials were compared in terms of their effect on rope twist.

- Different shaft sizes possible.
- Groove may be adjusted to other wire rope diameters.

[... Read more](#)

Sheave with Cylindrical Roller Bearings, Rigging

Blueprint

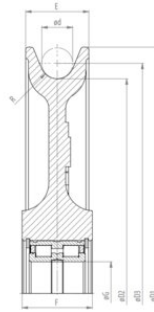

Technical data

Part code	Rope Ø range mm	Shaft Ø mm	Groove radius	Sheave dia. mm	øD2 mm in	øG mm in	Rmm in	øD1 in	øD3 in	E in	F in	Weight lb
140101100260	11	40	6	250/210	8.27	1.57	0.24	9.84	8.7	1.38	1.5	14.33
140101200261	12	30	6.5	150/120	4.72	1.18	0.26	5.91	5.2	1.42	1.57	6.61
140101200260	12	25	6.5	150/120	4.72	0.98	0.26	5.91	5.2	1.42	1.57	14.55
140101400260	14	30	7.5	200/165	6.5	1.18	0.3	7.87	7.05	1.42	1.57	9.92
140101600260	16	50	8.5	300/255	10.04	1.97	0.33	11.81	10.67	1.38	1.57	19.4
140101800261	18	40	9.8	250/210	8.27	1.57	0.39	9.84	8.98	1.34	1.5	13.45
140101800260	18	35	9.5	250/210	8.27	1.38	0.37	9.84	8.98	1.57	1.77	17.64
140101800263	18	40	9.5	250/210	8.27	1.57	0.37	9.84	8.98	1.57	1.77	17.64
140101800264	18	60	8.5	350/305	12.01	2.36	0.33	13.78	12.64	1.77	1.81	29.98
140101800265	18	120	9.5	400/345	13.58	4.72	0.37	15.75	14.29	1.97	2.13	47.62
140102000260	20	40	11	300/255	10.04	1.57	0.43	11.81	10.83	1.77	1.97	26.46
140102000261	20	80	11	450/390	15.35	3.15	0.43	17.72	16.14	2.36	2.36	68.34
140102200260	22	60	12	250/195	7.68	2.36	0.47	9.84	8.54	1.97	2.36	28.66
140102200261	22	45	12	350/305	12.01	1.77	0.47	13.78	12.87	1.77	1.97	37.48
140102200262	22	90	12	500/430	16.93	3.54	0.47	19.69	17.8	2.76	2.64	99.21
140102400260	24	65	13	300/250	9.84	2.56	0.51	11.81	10.79	2.17	2.36	28.66
140102400261	24	50	13	400/345	13.58	1.97	0.51	15.75	14.53	2.17	2.36	52.91
140102600260	26	75	14	350/305	12.01	2.95	0.55	13.78	13.03	2.76	2.76	50.71
140102800260	28	90	15	400/345	13.58	3.54	0.59	15.75	14.69	2.95	2.13	66.14
140102800261	28	55	15	450/390	15.35	2.17	0.59	17.72	16.46	2.36	2.76	105.82
140103000260	30	60	16	500/430	16.93	2.36	0.63	19.69	18.11	2.76	3.15	97
140103200260	32	100	17	450/390	15.35	3.94	0.67	17.72	16.61	2.95	3.35	83.78

Sheave with Cylindrical Roller Bearings, Rigging

Technical data

Part code	Rope Ø range mm	Shaft Ø mm	Groove radius	Sheave dia. mm	øD2 mm in	øG mm in	Rmm in	øD1 in	øD3 in	E in	F in	Weight lb
140103400260	34	70	18	550/480	18.9	2.76	0.71	21.65	20.24	2.76	3.15	121.25
140103600260	36	120	19.5	500/430	16.93	4.72	0.77	19.69	18.35	2.95	4.13	169.76
140103600261	36	80	19	600/520	20.47	3.15	0.75	23.62	21.89	3.35	4.13	176.37
140103900260	39	100	20.5	665/560	22.05	3.94	0.81	26.18	23.58	3.94	4.33	242.51
140104000260	40	120	21.5	550/480	18.9	4.72	0.85	21.65	20.47	3.15	4.13	209.44
140104000261	40	120	21.5	710/630	24.8	4.72	0.85	27.95	26.38	3.35	4.33	275.58
140104200260	42	150	22.5	810/710	27.95	5.91	0.89	31.89	29.61	3.86	3.94	418.88
140104400260	44	150	23.5	810/710	27.95	5.91	0.93	31.89	29.69	3.86	3.94	288.81
140104400261	44	160	23.5	920/800	31.5	6.3	0.93	36.22	33.23	3.94	4.29	473.99
140104800260	48	160	25.5	1030/920	36.22	6.3	1	40.55	38.11	5.12	5.91	837.76
140105200260	52	180	27.5	1160/1020	40.16	7.09	1.08	45.67	42.2	5.51	6.3	1,190.5