

Sheave with Bronze Bushing, Rigging

Product information



Self-lubricating cast sheaves are often applied in lifting, luffing and wire rope routing with intensive operating cycles. The groove opening angle was carefully designed to reduce potential twist resulting from fleet angles. In combination with the self-lubricating effect, the wire rope in your system will last longer. The latter was proved in recent research, in which several sheave materials were compared in terms of their effect on rope twist.

- Different shaft sizes possible.
- Groove may be adjusted to other wire rope diameters.

[... Read more](#)

Material: Cast steel GGG-60, GGG-70, GS20Mn5 or GS30Mn5 depending on model

Sheave with Bronze Bushing, Rigging

Blueprint

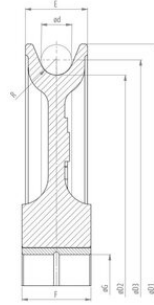

Technical data

Part code	Rope Ø range mm	Bearing	Shaft Ø mm	Groove radius	Sheave dia. mm	Ø D1 mm in	Ø D2 mm in	Ø D3 in	Ø G mm in	E in	F in	Rmm in	Ø d mm in	Weight lb
140100800221	8	Bronze bearing	15	4.5	100 / 80	3.94	3.15	3.46	0.59	0.71	0.79	0.18	0.31	1.32
140101000221	10	Bronze bearing	22	5.5	125 / 105	4.92	4.13	4.53	0.87	0.91	1.06	0.22	0.39	3.31
140101200221	12	Bronze bearing	30	6.5	150 / 120	5.91	4.72	5.2	1.18	1.42	1.57	0.26	0.47	6.61
140101200222	12	Bronze bearing	50	12	350 / 305	13.78	12.01	12.87	1.97	1.77	1.97	0.47	0.87	30.64
140101400221	14	Bronze bearing	30	7.5	250 / 165	7.87	6.5	7.05	1.18	1.42	1.57	0.3	0.55	9.92
140101600221	16	Bronze bearing	50	8.5	300 / 250	11.81	9.84	10.47	1.97	1.77	2.36	0.33	0.63	30.64
140101800221	18	Bronze bearing	35	9.5	250 / 210	9.84	8.27	8.98	1.38	1.57	1.77	0.37	0.71	17.64
140102000221	20	Bronze bearing	40	11	300 / 255	11.81	10.04	10.83	1.57	1.77	1.97	0.43	0.79	26.46
140102200222	22	Bronze bearing	60	12	250 / 195	9.84	7.68	8.54	2.36	1.97	1.97	0.47	0.87	26.46
140102200221	22	Bronze bearing	45	12	350 / 305	13.78	12.01	12.87	1.77	1.77	1.97	0.47	0.87	37.48
140102400222	24	Bronze bearing	70	13	300 / 250	11.81	9.84	10.79	2.76	2.17	2.36	0.51	0.94	33.07
140102400224	24	Bronze bearing	60	13	400 / 345	15.75	13.58	14.53	2.36	2.17	2.36	0.51	0.94	50.27
140102400223	24	Bronze bearing	55	13	400 / 345	15.75	13.58	14.53	2.17	2.17	2.56	0.51	0.94	51.59
140102400222	24	Bronze bearing	50	13	400 / 345	15.75	13.58	14.53	1.97	2.17	2.56	0.51	0.94	52.03
140102400221	24	Bronze bearing	50	13	400 / 345	15.75	13.58	14.53	1.97	2.17	2.36	0.51	0.94	52.91
140102600221	26	Bronze bearing	70	14	350 / 305	13.78	12.01	13.03	2.76	2.76	2.95	0.55	1.02	44.09
140102800223	28	Bronze bearing	80	15	300 / 240	11.81	9.45	10.55	3.15	2.28	2.44	0.59	1.1	26.24
140102800224	28	Bronze bearing	80	15	365 / 300	14.37	11.81	12.91	3.15	2.28	2.44	0.59	1.1	34.61
140102800226	28	Bronze bearing	70	15	400 / 345	15.75	13.58	14.69	2.76	2.17	2.76	0.59	1.1	49.6
140102800225	28	Bronze bearing	60	15	400 / 345	15.75	13.58	14.69	2.36	2.17	2.76	0.59	1.1	50.71
140102800222	28	Bronze bearing	80	15	400 / 345	15.75	13.58	14.69	3.15	2.95	3.15	0.59	1.1	70.55
140102800227	28	Bronze bearing	60	16	450 / 390	17.72	15.35	16.46	2.36	2.36	2.76	0.63	1.1	70.55

Sheave with Bronze Bushing, Rigging

Technical data

Part code	Rope Ø range mm	Bearing	Shaft Ø mm	Groove radius	Sheave dia. mm	Ø D1 mm in	Ø D2 mm in	Ø D3 in	Ø G mm in	E in	F in	Rmm in	Ø d mm in	Weight lb
140102800221	28	Bronze bearing	55	15	450 / 390	17.72	15.35	16.46	2.17	2.36	2.76	0.59	1.1	79.37
140102800228	28	Bronze bearing	80	20	450 / 390	17.72	15.35	16.85	3.15	2.76	3.15	0.79	1.1	88.18
140103000223	30	Bronze bearing	70	16	400 / 345	15.75	13.58	14.76	2.76	2.17	2.76	0.63	1.18	49.16
140103000222	30	Bronze bearing	60	16	400 / 345	15.75	13.58	14.76	2.36	2.17	2.76	0.63	1.18	50.27
140103000224	30	Bronze bearing	70	16	450 / 390	17.72	15.35	16.54	2.76	2.36	2.76	0.63	1.18	68.34
140103000221	30	Bronze bearing	60	16	500 / 430	19.69	16.93	18.11	2.36	2.76	3.15	0.63	1.18	97
140103200222	32	Bronze bearing	80	17	365 / 300	14.37	11.81	13.07	3.15	2.28	2.44	0.67	1.26	33.29
140103200223	32	Bronze bearing	80	17	400 / 345	15.75	13.58	14.84	3.15	2.76	3.15	0.67	1.26	68.34
140103200224	32	Bronze bearing	80	17	450 / 390	17.72	15.35	16.61	3.15	2.76	3.15	0.67	1.26	90.39
140103200226	32	Bronze bearing	100	17	495 / 430	19.49	16.93	18.19	3.94	2.76	3.15	0.67	1.26	94.8
140103200225	32	Bronze bearing	80	17	495 / 430	19.49	16.93	18.19	3.15	2.76	3.15	0.67	1.26	97
140103200221	32	Bronze bearing	80	17	450 / 390	17.72	15.35	16.61	3.15	2.95	3.35	0.67	1.26	105.82
140203200227	32	Bronze bearing	120	17	595 / 520	23.43	20.47	21.73	4.72	2.76	3.15	0.67	1.26	141.1
140103400221	34	Bronze bearing	70	18	500 / 480	21.65	18.9	20.24	2.76	2.76	3.15	0.71	1.34	121.25
140103600223	36	Bronze bearing	80	19	400 / 345	15.75	13.58	15	3.15	2.76	3.15	0.75	1.42	66.14
140103600222	36	Bronze bearing	80	19	450 / 390	17.72	15.35	16.77	3.15	2.76	3.15	0.75	1.42	88.18
140103600221	36	Bronze bearing	80	19.5	600 / 520	23.62	20.47	21.93	3.15	3.35	4.13	0.77	1.46	176.37
140103700222	37	Bronze bearing	90	19.5	450 / 390	17.72	15.35	16.81	3.54	2.95	3.35	0.77	1.46	90.39
140103700221	37	Bronze bearing	80	19.5	450 / 390	17.72	15.35	16.81	3.15	2.95	3.15	0.77	1.46	92.59
140103700223	37	Bronze bearing	100	19.5	500 / 430	19.69	16.93	18.39	3.94	3.54	3.94	0.77	1.46	176.37
140103800221	38	Bronze bearing	70	15	450 / 390	17.72	15.35	16.46	2.76	2.36	2.76	0.59	1.5	70.55
140103800223	38	Bronze bearing	100	20	495 / 430	19.49	16.93	18.43	3.94	2.76	3.15	0.79	1.5	92.59
140103800222	38	Bronze bearing	80	20	495 / 430	19.49	16.93	18.43	3.15	2.76	3.15	0.79	1.5	94.8
140103800224	38	Bronze bearing	120	20	595 / 520	23.43	20.47	21.97	4.72	3.15	3.54	0.79	1.5	149.91
140103900221	39	Bronze bearing	100	20.5	665 / 560	26.18	22.05	23.58	3.94	3.94	4.33	0.81	1.54	242.51
140104000222	40	Bronze bearing	120	21.5	500 / 480	21.65	18.9	20.47	4.72	3.94	4.72	0.85	1.57	176.37
140104000221	40	Bronze bearing	120	21.5	700 / 630	27.95	24.8	26.38	4.72	3.35	4.33	0.85	1.57	275.58
140104100221	41	Bronze bearing	160	22	1030 / 920	40.55	36.22	37.83	6.3	5.12	5.91	0.87	1.61	837.76
140104400223	44	Bronze bearing	120	23.5	595 / 520	23.43	20.47	22.2	4.72	3.15	3.54	0.93	1.73	145.51
140104400221	44	Bronze bearing	150	23.5	810 / 710	31.89	27.95	29.69	5.91	3.86	5.12	0.93	1.73	374.79
140104400222	44	Bronze bearing	150	22	920 / 800	36.22	31.5	33.23	5.91	5.12	5.91	0.87	1.73	595.25

Sheave with Bronze Bushing, Rigging

Technical data

Part code	Rope Ø range mm	Bearing	Shaft Ø mm	Groove radius	Sheave dia. mm	Ø D1 mm in	Ø D2 mm in	Ø D3 in	Ø G mm in	E in	F in	Rmm in	Ø d mm in	Weight lb
140104600221	46	Bronze bearing	180	24.5	1160 / 1020	45.67	40.16	41.97	7.09	5.51	6.3	0.96	1.81	1,190.5
140105200221	52	Bronze bearing	120	27.5	595 / 520	23.43	20.47	22.52	4.72	3.15	3.54	1.08	2.05	141.1