

## Sheave with Ball Bearings, Rigging

---

### Product information



Self-lubricating cast sheaves are often applied in lifting, luffing and wire rope routing with intensive operating cycles. The groove opening angle was carefully designed to reduce potential twist resulting from fleet angles. In combination with the self-lubricating effect, the wire rope in your system will last longer. The latter was proved in recent research, in which several sheave materials were compared in terms of their effect on rope twist.

- Different shaft sizes possible.
- Groove may be adjusted to other wire rope diameters.

[... Read more](#)

---

## Sheave with Ball Bearings, Rigging

### Blueprint

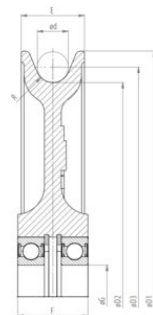

### Technical data

Part code	Rope Ø range mm	Material	Shaft Ø mm	Groove radius	Sheave dia. mm	Bearing	ØD2 mm in	ØG mm in	Rmm in	ØD1 mm in	ØD3 mm in	E in	F in	Weight lb
140100800233	8	GGG-60	15	4.5	100 / 80	2x6002-RS	3.15	0.59	0.18	3.94	3.46	0.71	0.79	1.54
140101000233	10	GGG-60	22	5.5	125 / 105	2x6022-RS	4.13	0.87	0.22	4.92	4.53	0.91	1.08	3.31
140101200233	12	GGG-60	30	6.5	150 / 120	2x6206-RS	4.72	1.18	0.26	5.91	5.2	1.42	1.57	6.61
140101400233	14	GGG-60	30	7.5	200 / 165	2x6206-RS	6.5	1.18	0.3	7.87	7.05	1.42	1.57	9.92
140101800233	18	GGG-60	35	9.5	250 / 210	2x6207-RS	8.27	1.38	0.37	9.84	8.98	1.57	1.77	17.64
140102000233	20	GGG-60	40	11	300 / 255	2x6208-RS	10.04	1.57	0.43	11.81	10.83	1.77	1.97	26.46
140102200233	22	GGG-70	45	12	350 / 305	2x6209-RS	12.01	1.77	0.47	13.78	12.87	1.77	1.97	37.48
140102400233	24	GGG-70	50	13	400 / 345	2x6210-RS	13.58	1.97	0.51	15.75	14.53	2.17	2.36	52.91