

## Vertical Directional Blocks

---

### Product information



#### General:

- Groove in sheave may be adjusted to other wire rope diameters.
- No test certificate possible.

... [Read more](#)

---

## Vertical Directional Blocks

### Blueprint

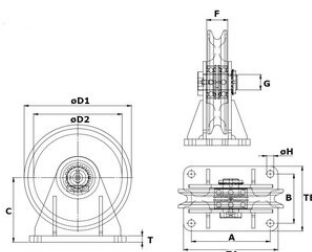

### Technical data

Part code	Rope Ø range mm	WLL (metric) tonnes	Bearing	Bearing	øD1 in	øD2 in	A in	B in	C in	F in	G, in	øH in	T in	TA mm in	TBmm in	Weight lb
140101000361	10	1	Bronze bearing	Bronze	4.92	4.13	3.54	2.76	3.27	1.06	0.87	0.35	0.31	4.53	3.74	6.61
140101000363	10	1	Ball bearing	2 x Ball	4.92	4.13	3.54	2.76	3.27	1.06	0.87	0.35	0.31	4.53	3.74	6.61
140101200361	12	2	Bronze bearing	Bronze	5.91	4.72	4.53	3.35	3.74	1.57	1.18	0.43	0.39	5.51	4.33	11.02
140101200363	12	2	Ball bearing	2 x Ball	5.91	4.72	4.53	3.35	3.74	1.57	1.18	0.43	0.39	5.51	4.33	11.02
140101400361	14	3	Bronze bearing	Bronze	7.87	6.5	5.91	3.74	4.8	1.57	1.18	0.53	0.47	7.09	4.92	17.64
140101400363	14	3	Ball bearing	2 x Ball	7.87	6.5	5.91	3.74	4.8	1.57	1.18	0.53	0.47	7.09	4.92	17.64
140101800361	18	4	Bronze bearing	Bronze	9.84	8.27	7.48	4.72	6.1	1.77	1.38	0.69	0.59	9.06	6.3	37.48
140101800364	18	4	Roller bearing	Straight	9.84	8.27	7.48	4.72	6.1	1.77	1.38	0.69	0.59	9.06	6.3	37.48
140102000361	20	6	Bronze bearing	Bronze	11.81	10.04	8.66	5.91	7.28	1.97	1.57	0.87	0.79	10.63	7.87	57.32
140102000364	20	6	Roller bearing	Straight	11.81	10.04	8.66	5.91	7.28	1.97	1.57	0.87	0.79	10.63	7.87	57.32
140102200361	22	8	Bronze bearing	Bronze	13.78	12.01	10.63	6.69	8.66	1.97	1.77	1.02	0.98	12.99	8.66	90.39
140102200364	22	8	Roller bearing	Straight	13.78	12.01	10.63	6.69	8.66	1.97	1.77	1.02	0.98	12.99	8.66	90.39
140102400361	24	10	Bronze bearing	Bronze	15.75	13.58	11.81	7.48	10.04	2.36	1.97	1.26	1.18	14.57	10.24	141.1
140102400364	24	10	Roller bearing	Straight	15.75	13.58	11.81	7.48	10.04	2.36	1.97	1.26	1.18	14.57	10.24	141.1