

Horizontal Directional Blocks

Product information

- No test certificate possible.
- Groove in sheave may be adjusted to other wire rope diameters.

... [Read more](#)



Horizontal Directional Blocks

Blueprint

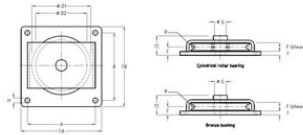

Technical data

Part code	Rope Ø range mm	WLL (metric) tonnes	Bearing	Bearing	A in	B in	C in	D1 in	D2mm in	F in	G, in	H, in	T in	Rmm in	TA mm in	TBmm in	TC mm in	Ø D1 mm in	Ø D2 mm in	ØG mm in	Weight lb
140101000211	10	1	Bronze bearing	Bronze	7.09	5.91	0.89	4.92	4.13	1.06	0.87	0.35	0.31	0.22	7.87	6.69	2.13	-	-	-	11.02
140101000213	10	1	Ball bearing	2 x Ball	7.09	5.91	0.89	-	-	1.06	-	0.35	0.31	0.22	7.87	6.69	2.13	4.92	4.13	0.87	11.02
140101200211	12	2	Bronze bearing	Bronze	8.66	7.48	1.22	5.91	4.72	1.57	1.18	0.43	0.39	0.26	9.84	8.66	2.83	-	-	-	22.05
140101200213	12	2	Ball bearing	2 x Ball	8.66	7.48	1.22	-	-	1.57	-	0.43	0.39	0.26	9.84	8.66	2.83	5.91	4.72	1.18	22.05
140101400211	14	3	Bronze bearing	Bronze	11.42	9.45	1.3	7.87	6.5	1.57	1.18	0.53	0.47	0.3	12.6	10.63	2.99	-	-	-	37.48
140101400213	14	3	Ball bearing	2 x Ball	11.42	9.45	1.3	-	-	1.57	-	0.53	0.47	0.3	12.6	10.63	2.99	7.87	6.5	1.18	37.48
140101800211	18	4	Bronze bearing	Bronze	14.17	12.2	1.52	9.84	8.27	1.77	1.38	0.69	0.59	0.37	15.75	13.78	3.39	-	-	-	70.55
140101800214	18	4	Roller bearing	Straight	14.17	12.2	1.52	-	-	1.77	-	0.69	0.59	0.37	15.75	13.78	3.39	9.84	8.27	1.38	70.55
140102000211	20	6	Bronze bearing	Bronze	15.75	14.17	1.81	11.81	10.04	1.97	1.57	0.87	0.79	0.43	17.72	16.14	3.9	-	-	-	110.23
140102000214	20	6	Roller bearing	Straight	15.75	14.17	1.81	-	-	1.97	-	0.87	0.79	0.43	17.72	16.14	3.9	11.81	10.04	1.57	110.23
140102200211	22	8	Bronze bearing	Bronze	18.11	16.54	1.81	13.78	12.01	1.97	1.77	1.02	0.79	0.47	20.47	18.9	3.9	-	-	-	154.32
140102200214	22	8	Roller bearing	Straight	18.11	16.54	1.81	-	-	1.97	-	1.02	0.79	0.47	20.47	18.9	3.9	13.78	12.01	1.77	154.32
140102400211	24	10	Bronze bearing	Bronze	20.87	18.9	2.01	15.75	13.58	2.36	1.97	1.26	0.79	0.51	23.62	21.65	4.45	-	-	-	220.46
140102400214	24	10	Roller bearing	Straight	20.87	18.9	2.01	-	-	2.36	-	1.26	0.79	0.51	23.62	21.65	4.45	15.75	13.58	1.97	220.46

Horizontal Directional Blocks
