

## Fast Reeve Crane Blocks 3 sheave

---

### Product information



#### General:

- Standard Reeve Crane Blocks may be used on a wide variety of land based cranes such as mobile and crawler cranes. They are an excellent choice where frequent block change is required.
- Double sealed maintenance free roller bearings.
- Design Factor of Safety of 4:1.
- Forged high tensile steel DIN hooks.
- Ductile iron sheaves, featuring graphite lubricated groove.
- High impact resistant side plates.
- Operational temperature range -40 up to +80°C.
- Lubrication on hook suspension.
- 4 or 8 point hook locking device.
- Fast reeve guide for fast reeving.
- Safety latch with locking pin.
- C3M finish in signal yellow with black striping.

#### Options:

- Double hook.
- Double hook with shackle hole.
- Quad hook.
- Shackle stud eye.

#### Important:

**Inquiries for custom versions are welcome!**

... [Read more](#)

---

## Fast Reeve Crane Blocks 3 sheave

### Blueprint

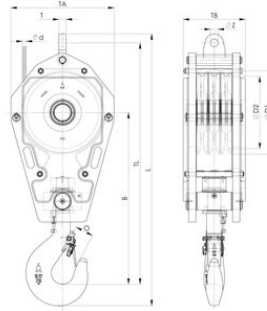

### Technical data

Part code	WLL (metric) tonnes	Model	Rope Ø mm	Sheave dia. mm	Hooksize	B in	L in	Omm in	T in	TA mm in	TBmm in	TLmm in	øD1 in	øD2 in	øZ in	Weight lb
6097FRB22514320E	20	FRB 225 .14 .3 .20 .E	14	260 / 225	8	28.27	44.41	2.72	1.1	13.58	7.09	39.09	10.24	8.86	1.26	286.6
6097FRB32016320E	20	FRB 320 .16 .3 .20 .E	16	365 / 320	8	30.04	48.46	2.72	1.1	17.72	7.09	43.15	14.37	12.6	1.26	352.74
6097FRB26014320E	20	FRB 260 .14 .3 .20 .E	14	300 / 260	8	28.46	45.39	2.72	1.1	15.75	8.66	40.08	11.81	10.24	1.26	407.86
6097FRB32016325E	25	FRB 320 .16 .3 .25 .E	16	365 / 320	8	30.04	48.46	2.72	1.1	17.72	8.66	43.15	14.37	12.6	1.26	451.95
6097FRB26014325E	25	FRB 260 .14 .3 .25 .E	14	300 / 260	8	27.48	44.41	2.72	1.1	15.75	10.24	39.09	11.81	10.24	1.26	462.97
6097FRB28516329E	29	FRB 285 .16 .3 .29 .E	16	320 / 280	8	27.68	45.2	2.72	1.1	16.54	7.09	39.88	12.6	11.02	1.26	462.97
6097FRB32016329EA	29	FRB 320 .16 .3 .29 .E .A	16	365 / 320	8	30.04	48.46	2.72	1.1	17.72	8.66	43.15	14.37	12.6	1.26	462.97
6097FRB32016329EB	29	FRB 320 .16 .3 .29 .E .B	16	365 / 320	8	30.04	48.46	2.72	1.1	17.72	9.06	43.15	14.37	12.6	1.26	496.04
6097FRB35519332E	32	FRB 355 .19 .3 .32 .E	19	410 / 355	10	33.98	53.5	2.99	1.38	19.69	11.02	47.56	16.14	13.98	1.46	815.71
6097FRB36019340E	40	FRB 360 .19 .3 .40 .E	19	420 / 360	12	35.39	55.79	3.31	1.38	20.08	13.46	49.37	16.54	14.17	1.46	1,003.1
6097FRB40019340E	40	FRB 400 .19 .3 .40 .E	19	460 / 400	12	36.54	58.5	3.31	1.38	22.44	13.5	52.09	18.11	15.75	1.46	1,102.31
6097FRB40019350E	50	FRB 400 .19 .3 .50 .E	19	460 / 400	16	37.36	59.09	3.82	1.38	22.44	13.5	52.13	18.11	15.75	1.46	1,190.5
6097FRB40022350E	50	FRB 400 .22 .3 .50 .E	22	460 / 400	16	37.36	59.29	3.82	1.57	22.44	13.5	52.13	18.11	15.75	1.69	1,190.5
6097FRB36019350E	50	FRB 360 .19 .3 .50 .E	19	420 / 360	16	35.39	56.34	3.82	1.38	20.08	15.83	49.37	16.54	14.17	1.46	1,223.57
6097FRB45022363E	63	FRB 450 .22 .3 .63 .E	22	515 / 450	16	40.87	64.17	3.82	1.57	23.62	11.93	57.01	20.28	17.72	1.69	1,322.77
6097FRB45024363EA	63	FRB 450 .24 .3 .63 .E .A	24	515 / 450	16	40.87	64.8	3.82	1.77	23.62	12.32	57.24	20.28	17.72	2.05	1,433.01
6097FRB45026363EA	63	FRB 450 .26 .3 .63 .E .A	26	515 / 450	16	40.87	65.08	3.82	1.77	23.62	12.32	57.52	20.28	17.72	2.05	1,433.01
6097FRB45024363EB	63	FRB 450 .24 .3 .63 .E .B	24	515 / 450	16	40.87	64.8	3.82	1.77	23.62	14.29	57.24	20.28	17.72	2.05	1,697.56

## Fast Reeve Crane Blocks 3 sheave

### Technical data

Part code	WLL (metric) tonnes	Model	Rope Ø mm	Sheave dia. mm	Hooksize	B in	L in	Omm in	T in	TA mm in	TBmm in	TLmm in	øD1 in	øD2 in	øZ in	Weight lb
6097FRB45026363EB	63	FRB 450 .26 .3 .63 .E .B	26	515 / 450	16	40.87	65.08	3.82	1.77	23.62	14.29	57.52	20.28	17.72	2.05	1,697.56
6097FRB45026380E	80	FRB 450 .26 .3 .80 .E	26	515 / 450	20	46.54	71.46	4.33	1.77	23.62	14.25	63.19	20.28	17.72	2.05	1,785.75
6097FRB52824380E	80	FRB 528 .24 .3 .80 .E	24	595 / 528	20	50.08	76.61	4.33	1.77	27.95	16.22	68.35	23.43	20.79	2.05	2,491.23
6097FRB52826380E	80	FRB 528 .26 .3 .80 .E	26	595 / 528	20	50.08	76.61	4.33	1.77	27.95	16.22	68.35	23.43	20.79	2.05	2,491.23
6097FRB52828380E	80	FRB 528 .28 .3 .80 .E	28	595 / 528	20	50.08	77.6	4.33	1.97	27.95	16.22	68.94	23.43	20.79	2.32	2,491.23
6097FRB528263100E	100	FRB 528 .26 .3 .100 .E	26	595 / 528	25	53.66	80.94	5.2	1.77	27.95	18.19	71.89	23.43	20.79	2.05	2,998.29
6097FRB528283100E	100	FRB 528 .28 .3 .100 .E	28	595 / 528	25	53.66	81.93	5.2	1.97	27.95	18.19	72.48	23.43	20.79	2.32	2,998.29
6097FRB575283100E	100	FRB 575 .28 .3 .100 .E	28	650 / 575	25	51.3	80.63	5.2	1.97	30.31	17.01	71.18	25.59	22.64	2.32	2,998.29
6097FRB670283125E	125	FRB 670 .28 .3 .125 .E	28	760 / 670	25	56.22	87.91	5.2	1.97	34.25	24.49	78.46	29.92	26.38	2.32	6,393.41
6097FRB670323125E	125	FRB 670 .32 .3 .125 .E	32	760 / 670	25	56.22	88.11	5.2	2.36	34.25	24.49	78.46	29.92	26.38	2.6	6,393.41