

Lever Hoist KITO LB Series

Product information



The KITO LB leverhoist is built with premium grade components and makes it particularly suitable for continuous operation under most severe conditions.

Features:

- Standard supplied with a unique freewheel chain adjusting mechanism with overload protection.
- Rugged and ergonomic lever handle.
- Smooth geared mechanism for effortless handling.
- Robust mechanical load brake increases the safety of the operator.
- Double-reduction gearing requires minimum manual power for operation at full load.
- Open load sheave allows easy inspection and cleaning without dismantling the unit.
- Sealed gears and brake are protected against damage from dust and water.
- Fourfold riveted and forged carbon steel bottom hook.
- Abrasion-resistant nickel-plated load chain V(G100) for high and uniform strength (1000 N/mm²), in accordance with standard DIN EN 818-7.

Optional:

- Friction clutch
- Overload signal
- Wire rope clip
- Shipyard hooks
- Without freewheel mechanism

... [Read more](#)

Material: High grade Steel housing, nickel-plated load chain, Carbon steel hooks

Marking: According to standard, CE-marked

Standard: EN 13157

Warning: Minimum load is needed for the load pressure brake to work correct.

Safety factor: 4:1

Lever Hoist KITO LB Series

Blueprint

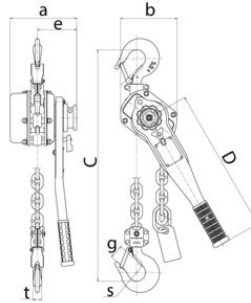

Technical data

Part code	Code	WLL (metric) tonnes	Lifting height m	Number of falls	Min. load kg	Load chain mm	A in	B in	C in	D, in	e mm in	g mm in	S in	t in	Weight lb
500500080150037	LB008S015	0.8	1.5	1	25	5.6 x 15.7	4.49	4.69	11.02	9.65	3.82	0.93	1.28	0.55	12.57
500500080150034	LB008L015	0.8	1.5	1	25	5.6 x 15.7	4.49	4.69	11.02	9.65	3.82	0.93	1.28	0.55	12.57
500500080150035	LB008O015	0.8	1.5	1	25	5.6 x 15.7	4.49	4.69	11.02	9.65	3.82	0.93	1.28	0.55	12.57
500500080150030	Without freewheel function (OF)	0.8	1.5	1	25	5.6 x 15.7	4.49	4.69	11.02	9.65	3.82	0.93	1.28	0.55	12.57
500500080200030	LB008S020	0.8	2	1	25	5.6 x 15.7	4.49	4.69	11.02	9.65	3.82	0.93	1.28	0.55	13.34
500500080300036	LB008O030	0.8	3	1	25	5.6 x 15.7	4.49	4.69	11.02	9.65	3.82	0.93	1.28	0.55	14.88
500500080300030	LB008S030	0.8	3	1	25	5.6 x 15.7	4.49	4.69	11.02	9.65	3.82	0.93	1.28	0.55	14.99
500500080600030	LB008S060	0.8	6	1	25	5.6 x 15.7	4.49	4.69	11.02	9.65	3.82	0.93	1.28	0.55	19.62
500500081050030	LB008S105	0.8	10.5	1	25	5.6 x 15.7	4.49	4.69	11.02	9.65	3.82	0.93	1.28	0.55	26.46
500500080000030	LB008	0.8	-	1	25	5.6 x 15.7	4.49	4.69	11.02	9.65	3.82	0.93	1.28	0.55	-
500500100100036	LB010S010	1	1	1	25	5.6 x 15.7	4.49	4.69	11.81	9.65	3.82	1.14	1.67	0.59	12.24
500500100150031	LB010S015	1	1.5	1	25	5.6 x 15.7	4.49	4.69	11.81	9.65	3.82	1.14	1.67	0.59	12.57
500500100150030	LB010S015	1	1.5	1	25	5.6 x 15.7	4.49	4.69	11.81	9.65	3.82	1.14	1.67	0.59	13.01
500500100200030	LB010S020	1	2	1	25	5.6 x 15.7	4.49	4.69	11.81	9.65	3.82	1.14	1.67	0.59	13.78
500500100300034	LB010S030	1	3	1	25	5.6 x 15.7	4.49	4.69	11.81	9.65	3.82	1.14	1.67	0.59	15.43
500500100300035	LB010O030	1	3	1	25	5.6 x 15.7	4.49	4.69	11.81	9.65	3.82	1.14	1.67	0.59	15.43
500500100400030	LB010S040	1	4	1	25	5.6 x 15.7	4.49	4.69	11.02	9.65	3.82	0.93	1.28	0.55	16.98
500500100500030	LB010S050	1	5	1	25	5.6 x 15.7	4.49	4.69	11.81	9.65	3.82	1.14	1.67	0.59	18.41
500500100600030	LB010S060	1	6	1	25	5.6 x 15.7	4.49	4.69	11.81	9.65	3.82	1.14	1.67	0.59	20.06
500500160150035	LB016S015	1.6	1.5	1	38	7.1 x 19.9	6.26	4.96	13.19	10.43	3.94	1.26	1.67	0.75	17.64
500500160150034	LB016L015	1.6	1.5	1	38	7.1 x 19.9	6.26	4.96	13.19	10.43	3.94	1.26	1.67	0.75	17.64

Lever Hoist KITO LB Series

Technical data

Part code	Code	WLL (metric) tonnes	Lifting height m	Number of falls	Min. load kg	Load chain mm	A in	B in	C in	D, in	e mm in	g mm in	S in	t in	Weight lb
500500160150036	LB016O015	1.6	1.5	1	38	7.1 x 19.9	6.26	4.96	13.19	10.43	3.94	1.26	1.67	0.75	17.64
500500160200030	LB016S020	1.6	2	1	38	7.1 x 19.9	6.26	4.96	13.19	10.43	3.94	1.26	1.67	0.75	18.85
500500160250036	LB016S025	1.6	2.5	1	38	7.1 x 19.9	6.26	4.96	13.19	10.43	3.94	1.26	1.67	0.75	20.06
500500160300030	LB016O030	1.6	3	1	38	7.1 x 19.9	6.26	4.96	13.19	10.43	3.94	1.26	1.67	0.75	21.27
500500160300034	LB016S030	1.6	3	1	38	7.1 x 19.9	6.26	4.96	13.19	10.43	3.94	1.26	1.67	0.75	21.38
500500160400034	LB016S040	1.6	4	1	38	7.1 x 19.9	6.26	4.96	13.19	10.43	3.94	1.26	1.67	0.75	23.7
500500160500035	LB016S050	1.6	5	1	38	7.1 x 19.9	6.26	4.96	13.19	10.43	3.94	1.26	1.67	0.75	26.12
500500160600037	LB016S060	1.6	6	1	38	7.1 x 19.9	6.26	4.96	13.19	10.43	3.94	1.26	1.67	0.75	28.66
500500160600034	LB016O060	1.6	6	1	38	7.1 x 19.9	6.26	4.96	13.19	10.43	3.94	1.26	1.67	0.75	28.66
500500250150034	LB025S015	2.5	1.5	1	54	8.8 x 24.6	6.81	5.91	14.76	10.43	4.02	1.44	1.85	0.83	24.69
500500250150035	LB025O015	2.5	1.5	1	54	8.8 x 24.6	6.81	5.91	14.76	10.43	4.02	1.44	1.85	0.83	24.69
500500250300030	LB025S030	2.5	3	1	54	8.8 x 24.6	6.81	5.91	14.76	10.43	4.02	1.44	1.85	0.83	30.42
500500250600035	LB025S060	2.5	6	1	54	8.8 x 24.6	6.81	5.91	14.76	10.43	4.02	1.44	1.85	0.83	41.67
500500250600031	LB025O060	2.5	6	1	54	8.8 x 24.6	6.81	5.91	14.76	10.43	4.02	1.44	1.85	0.83	41.67
500500320150030	LB032S015	3.2	1.5	1	35	10.0 x 28.0	7.48	6.26	15.55	16.34	4.41	1.54	1.97	0.96	33.07
500500320150035	LB032L015	3.2	1.5	1	35	10.0 x 28.0	7.48	6.26	15.55	16.34	4.41	1.54	1.97	0.96	33.07
500500320150037	LB032O015	3.2	1.5	1	35	10.0 x 28.0	7.48	6.26	15.55	16.34	4.41	1.54	1.97	0.96	33.07
500500320250030	LB032S025	3.2	2.5	1	35	10.0 x 28.0	7.48	6.26	15.55	16.34	4.41	1.54	1.97	0.96	38.14
500500320300034	LB032S030	3.2	3	1	35	10.0 x 28.0	7.48	6.26	15.55	16.34	4.41	1.54	1.97	0.96	40.79
500500320300036	LB032O030	3.2	3	1	35	10.0 x 28.0	7.48	6.26	15.55	16.34	4.41	1.54	1.97	0.96	40.79
500500320500030	LB032S050	3.2	5	1	35	10.0 x 28.0	7.48	6.26	15.55	16.34	4.41	1.54	1.97	0.96	50.82
500500320600034	LB032S060	3.2	6	1	35	10.0 x 28.0	7.48	6.26	15.55	16.34	4.41	1.54	1.97	0.96	56
500500320600030	LB032O060	3.2	6	1	35	10.0 x 28.0	7.48	6.26	15.55	16.34	4.41	1.54	1.97	0.96	56
500500321000030	LB032S100	3.2	10	1	35	10.0 x 28.0	7.48	6.26	15.55	16.34	4.41	1.54	1.97	0.96	76.17
500500630150030	LB063S015	6.3	1.5	2	90	10.0 x 28.0	7.48	8.54	21.26	16.34	4.41	1.97	2.36	1.34	57.32
500500630300034	LB063S030	6.3	3	2	90	10.0 x 28.0	7.48	8.54	21.26	16.34	4.41	1.97	2.36	1.34	72.97
500500630600035	LB063S060	6.3	6	2	90	10.0 x 28.0	7.48	8.54	21.26	16.34	4.41	1.97	2.36	1.34	104.06
500500630800030	LB063S080	6.3	8	2	90	10.0 x 28.0	7.48	8.54	21.26	16.34	4.41	1.97	2.36	1.34	124.67
500500631000030	LB063S100	6.3	10	2	90	10.0 x 28.0	7.48	8.54	21.26	16.34	4.41	1.97	2.36	1.34	145.39
500500900150030	LB090S015	9	1.5	3	130	10.0 x 28.0	7.48	11.97	26.77	16.34	4.41	2.85	3.35	1.63	88.18
500500900300030	LB090S030	9	3	3	130	10.0 x 28.0	7.48	11.97	26.77	16.34	4.41	2.85	3.35	1.63	111.33

Lever Hoist KITO LB Series

Technical data

Part code	Code	WLL (metric) tonnes	Lifting height m	Number of falls	Min. load kg	Load chain mm	A in	B in	C in	D, in	e mm in	g mm in	S in	t in	Weight lb
500500900350030	LB090S035	9	3.5	3	130	10.0 x 28.0	7.48	11.97	26.77	16.34	4.41	2.85	3.35	1.63	119.05
500500900600030	LB090S060	9	6	3	130	10.0 x 28.0	7.48	11.97	26.77	16.34	4.41	2.85	3.35	1.63	157.63