

Beam Clamp - IPTKW

Product information



The IPTKW series beam clamp is suitable for use as a temporary tackle eye for a beam and it is an economy version of the IPTK model.

Features:

- Available in capacities of 2 thru 5 metric tons.
- Wide variety of jaw openings available: 75 to 350 mm.
- Welded alloy steel body for strength and smaller size. Forged alloy components, where required.
- Individually Proof Tested to 2 times the Working Load Limit with certification.
- User manual with test certificate is included with each clamp.
- Maintenance and repair kits are available.
- All sizes are RFID EQUIPPED.

... [Read more](#)

Material: Alloy steel

Marking: According to standard, CE-marked, WLL, Logo, Jaw opening, Serial number

Temperature range: -40°C up to +100°C

Standard: EN 13155

Beam Clamp - IPTKW

Blueprint

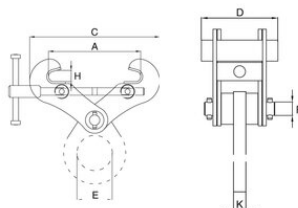

Technical data

Part code	WLL (metric) tonnes	Jaw width in	Model	A in	C mm	D, in	F in	H, in	Weight lb
502100201900220	2	2.95-7.48	2-IPTKW	2.95-7.48	A+80	4.92	1.1	0.98	8.82
502100301900220	3	2.95-7.48	3-IPTKW	2.95-7.48	A+80	4.92	1.1	0.98	9.92
502100402800220	4	5.91-11.02	4-IPTKW	5.91-11.02	A+100	4.92	1.3	1.38	13.89
502100503500220	5	4.72-13.78	5-IPTKW	4.72-13.78	A+195	4.92	1.3	1.57	19.4