

Beam Clamp - IPTK

Product information



This IPTK series beam clamp is suitable for use as a temporary tackle eye for horizontal lifting and transportation of steel (H) beams, profiles and structures. Can also be used as upside down attached (temporary) lifting point.

Features:

- Available in capacities of 2 through 25 metric tons.
- Wide variety of jaw openings available: 75 to 1020 mm.
- Welded alloy steel body for strength and smaller size. Forged alloy components, where required.
- Individually Proof Tested to 2 times the Working Load Limit with certification.
- User manual with test certificate is included with each clamp.
- Maintenance and repair kits are available.
- All sizes are RFID EQUIPPED.

... [Read more](#)

Material: Steel

Marking: According to standard, CE-marked, WLL, Logo, Jaw opening, Serial number

Temperature range: -40°C up to +100°C

Standard: EN 13155

Beam Clamp - IPTK

Blueprint

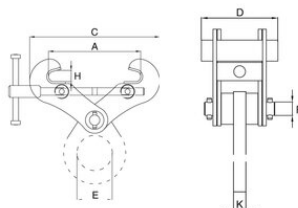

Technical data

Part code	WLL (metric) tonnes	Jaw width in	Model	A in	C mm	D, in	E in	H, in	K in	Weight lb
502100201900230	2	2.95-7.48	2-IPTK	2.95-7.48	A+80	4.92	2.95	0.98	0.79	13.23
502100301900230	3	2.95-7.48	3-IPTK	2.95-7.48	A+80	4.92	2.95	0.98	0.79	14.33
502100402800230	4	5.91-11.02	4-IPTK	5.91-11.02	A+100	4.92	2.95	1.38	0.79	18.74
502100503500230	5	4.72-13.78	5-IPTK	4.72-13.78	A+195	4.92	2.95	1.57	0.79	24.25
502102501020230	25	17.72	25-IPTK	17.72-40.16	A+220	19.69	4.92	2.99	1.77	496.04