

Chain Coupler Crosby S-1325A

Product information



Features:

- Locking system that provides for simple assembly and disassembly – no special tools required.
- Designed to connect Grade 100 chain fittings produced with “Engineered Flat” to Grade 100 chain.
- Suitable for use with Grade 100 and Grade 80 chain.
- Individually Proof Tested to 2-1/2 times the Working Load Limit with certification.
- Fatigue rated at 1-1/2 times the Working Load Limit at 20,000 cycles ... [Read more](#)

Material: Forged Alloy Steel - Quenched and Tempered.

Marking: Chain size, code and grade.

Finish: Painted.

Safety factor: 4:1

Grade: 10

Chain Coupler Crosby S-1325A

Blueprint

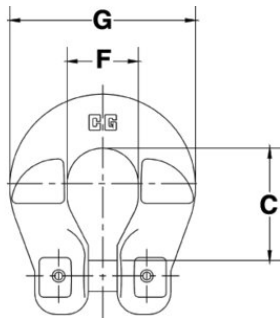

Technical data

Part code	Code	Chain diameter in	WLL lb	C in	F in	G, in	Weight lb
402200150010	S-1325A-6-10	-	3,200	1.03	0.76	1.76	0.24
402200200010	S-1325A-7-10	1/4	4,300	1.41	0.88	2.32	0.51
402200250010	S-1325A-8-10	5/16	5,700	1.4	0.88	2.32	0.51
402200400010	S-1325A-10-10	3/8	8,800	1.84	1.18	2.72	0.75
402200680010	S-1325A-13-10	1/2	15,000	2.19	1.5	3.72	1.65
402201030010	S-1325A-16-10	5/8	22,600	2.81	1.96	4.41	1.9