

Alloy Pear Shaped Links Crosby A-341

Product information

Individually Proof Tested at 2 times Working Load Limit with certification.

... [Read more](#)



Material: Alloy steel — Quenched & Tempered.

Safety factor: 5:1

Alloy Pear Shaped Links Crosby A-341

Blueprint

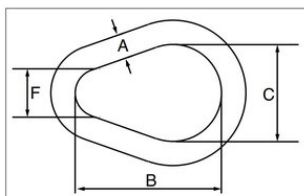

Technical data

Part code	Chain diameter in	WLL lb	A in	B in	C in	F in	Weight lb
40981013575	1/2	7,000	0.51	3	2	1	0.55
40981013584	5/8	9,000	0.63	3.75	2.5	1.25	1.1
40981013595	3/4	12,300	0.75	4.49	3	1.5	1.76
40981013604	7/8	15,000	0.87	5.24	3.5	1.75	2.82
40981013613	1	24,360	0.98	5.98	4.02	2.01	4.21
40981013622	1 1/8	30,600	1.1	6.73	4.49	2.24	6.24
40981013631	1 1/4	36,000	1.26	7.52	5	2.5	8.25
40981013640	1 3/8	43,000	1.38	8.27	5.51	2.76	11.24
40981013654	1 1/2	54,300	1.5	9.02	5.98	2.99	14.24
40981013672	1 3/4	84,900	1.73	10.51	7.01	3.5	22.49
40981013690	2	102,600	2.01	12.01	7.99	4.02	33.95