

## Open Spelter Socket McKissick G-416

---

### Product information



**Standard:** Fed Spec RR-S-550D TYPE A.

... [Read more](#)

**Features:** Spelter socket terminations have an efficiency rating of 100%, based on the catalogue strength of wire rope.

**Material:** Forged steel sockets through 1 1/2", cast alloy steel 1-5/8" through 4".

**Marking:** ID code and Manufacturer's symbol.

**Finish:** Galvanized.

# Open Spelter Socket McKissick G-416

## Blueprint

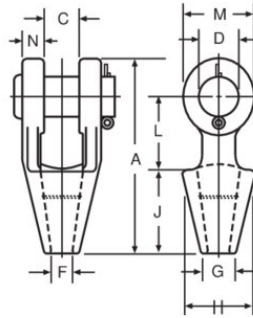

## Technical data

Part code	Rope Ø range mm	MBL tonnes	Finish	Rope Ø inch	A in	C in	D, in	F in	G, in	H, in	J in	L in	Mmm in	Nmm in	Weight lb
122101000062	8-10	12	Galvanized	5/16 - 3/8	4.84	0.81	0.81	0.5	0.81	1.69	2.24	1.75	1.5	0.44	1.3
122101300062	11-13	20	Galvanized	7/16 - 1/2	5.55	1	1	0.56	0.94	1.88	2.5	2.01	1.88	0.5	2.25
122101600062	14-16	27	Galvanized	9/16 - 5/8	6.73	1.25	1.19	0.69	1.13	2.24	2.99	2.5	2.24	0.56	3.59
122101800062	18	43	Galvanized	3/4	7.95	1.5	1.38	0.81	1.25	2.62	3.5	2.99	2.62	0.62	5.82
122102200062	20-22	55	Galvanized	7/8	9.25	1.75	1.63	0.94	1.5	3.25	4.02	3.5	3.13	0.8	9.66
122102600062	24-26	78	Galvanized	1	10.55	2.01	2.01	1.13	1.75	3.76	4.49	4.02	3.76	0.88	15.5
122103000062	28-30	92	Galvanized	1 1/8	11.81	2.24	2.24	1.25	2.01	4.13	5	4.61	4.13	1	21.5
122103500062	32-35	136	Galvanized	1 1/4 - 1 3/8	13.19	2.5	2.5	1.5	2.24	4.76	5.51	5	4.76	1.13	31.09
122103800062	38	170	Galvanized	1 1/2	15.12	2.99	2.76	1.63	2.76	5.24	5.98	5.98	5.39	1.19	47.18
122104200062	40-42	188	Galvanized	† 1 5/8	16.26	2.99	2.99	1.75	2.99	5.51	6.5	6.5	5.75	1.31	54.9
122104800062	44-48	268	Galvanized	† 1 3/4 - 1 7/8	18.27	3.5	3.5	2.01	3.13	6.38	7.52	7.01	6.5	1.56	82.01
122105400062	50-54	291	Galvanized	† 2 - 2 1/8	21.5	4.02	3.76	2.24	3.76	7.36	8.5	9.02	7.01	1.81	130.07
122106000062	56-60	360	Galvanized	† 2 1/4 - 2 3/8	23.5	4.49	4.25	2.5	4.02	8.27	9.02	10	7.76	2.13	167.55
122106700062	64-67	424	Galvanized	† 2 1/2 - 2 5/8	25.51	5	4.76	2.87	4.49	9.25	9.76	10.79	8.5	2.38	251.33
122107300062	70-73	511	Galvanized	† 2 3/4 - 2 7/8	27.24	5.24	5	3.11	4.88	10.51	10.98	10.98	9.02	2.87	315.26
122108000062	75-80	563	Galvanized	† 3 - 3 1/8	29.02	5.75	5.24	3.39	5.24	11.1	12.01	11.3	9.49	2.99	379.2
122108600062	82-86	722	Galvanized	† 3 1/4 - 3 3/8	30.87	6.26	5.51	3.62	5.75	11.89	12.99	11.81	10	3.11	434.31
122109200062	88-92	779	Galvanized	† 3 1/2 - 3 5/8	33.27	6.73	5.98	3.88	6.5	12.36	14.02	12.52	10.79	3.25	562.18
122110200062	94-102	875	Galvanized	† 3 3/4 - 4	36.26	7.52	7.01	4.25	7.24	13.62	15	13.5	12.52	3.5	782.64