

## Closed Spelter Socket G-417

### Product information



McKissick Closed spelter socket for steel wire rope  $\varnothing$  8 mm up to  $\varnothing$  102 mm. Spelter socket terminations have an efficiency rating of 100%, based on the catalogue strength of wire rope.

#### Features:

- Forged Steel Sockets through 38 mm, cast alloy steel 40 mm through 102mm.
- All cast steel sockets 40 mm and larger are magnetic particle inspected and ultrasonic inspected.
- Proof testing available on special order.
- Spelter socket terminations have an efficiency rating of 100%, based on the catalog strength of wire rope.
- Ratings are based on recommended use with 6x7, 6x19, or 6x37, IPS or XIP (EIP), XXIP (EEIP), RRL, FC, or IWRC wire rope.
- Strand constructed with minimal number of wires (e.g. 1x7) requires special consideration that socket basket length be five (5) times the strand diameter or fifty (50) times the wire diameter, whichever is the greater.
- Also available in self-coloured / ungalvanized version on request.

**Standard:** Fed Spec RR-S-550D TYPE B.

[... Read more](#)

**Material:** Forged steel from wire rope  $\varnothing$  8mm up to 38mm. From  $\varnothing$  40mm Cast Alloy steel.

**Marking:** ID code and Manufacturer's symbol.

**Finish:** Galvanized.

## Closed Spelter Socket G-417

### Blueprint

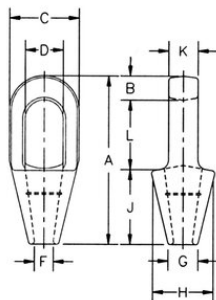

### Technical data

Part code	Rope Ø range mm	MBL tonnes	Finish	A in	B in	C in	D, in	F in	G, in	H, in	J in	K in	L in	Weight lb
122101000052	8-10	12	Galvanized	4.92	0.62	1.69	0.97	0.5	0.81	1.69	2.25	0.69	2.06	0.75
122101300052	11-13	20	Galvanized	5.51	0.69	2.01	1.16	0.56	0.94	2.01	2.5	0.88	2.31	1.5
122101600052	14-16	30.8	Galvanized	6.38	0.81	2.64	1.41	0.69	1.19	2.64	3	1	2.56	2.49
122101800052	18	43.5	Galvanized	7.64	1.06	3	1.66	0.88	1.31	2.76	3.5	1.25	3.06	4.23
122102200052	20-22	65.3	Galvanized	8.9	1.31	3.62	1.94	1	1.5	3.25	4.02	1.5	3.56	7.23
122102600052	24-26	81.6	Galvanized	10	1.44	4.13	2.3	1.13	1.75	3.76	4.49	1.75	4.06	10.49
122103000052	28-30	100	Galvanized	11.14	1.56	4.49	2.56	1.25	2.01	4.13	5	2.01	4.57	14.24
122103500052	32-35	136	Galvanized	12.17	1.63	5	2.8	1.5	2.3	4.69	5.43	2.22	5.08	19.73
122103800052	38	170	Galvanized	13.98	1.94	5.39	3.19	1.63	2.78	5.2	5.94	2.46	6.1	29.19
122104200052	40-42	188	Galvanized	15.35	2.13	5.75	3.25	1.75	3	5.51	6.5	2.76	6.73	35.98
122104800052	44-48	268	Galvanized	17.52	2.19	6.73	3.76	2.01	3.13	6.38	7.52	3	7.8	57.23
122105400052	50-54	309	Galvanized	19.88	2.44	7.64	4.37	2.25	3.76	7.36	8.5	3.25	8.82	78.99
122106000052	56-60	360	Galvanized	21.5	2.76	8.5	5	2.63	4.13	8.27	9.02	3.62	9.76	104.98
122106700052	64-67	424	Galvanized	23.5	3.13	9.49	5.51	2.93	4.49	9.25	9.76	4.02	10.63	139.99
122107300052	70-73	549	Galvanized	25.39	3.13	10.75	6.26	3.13	4.88	10.2	10.98	4.88	11.26	220
122108000052	75-80	656	Galvanized	27.13	3.37	11.5	6.73	3.39	5.24	11.5	12.01	5.24	11.73	275.58
122108600052	82-86	750	Galvanized	29.25	4.02	12.24	7.24	3.62	5.75	12.24	12.99	5.75	12.24	313.06
122109200052	88-92	820	Galvanized	30.98	4.02	12.99	7.76	3.88	6.3	12.99	14.02	6.26	12.99	399.04
122110200052	94-102	1,005	Galvanized	33.27	4.25	14.25	8.5	4.25	7.24	14.25	15	7.01	14.02	542.34