

## Snatch Block McKissick 421 with Shackle - Champion

### Product information



The McKissick snatch block 421 Champion from Crosby is a snatch block fitted with a shackle. Can be delivered with bronze bushing (BB) and with roller bearing (RB).

#### Features:

- Bolt for opening feature is retained, to ensure no lost bolts.
- Opening feature permits easy insertion of rope without reeving, or while the block is suspended.
- Center pin equipped with pressure lube fitting.
- All sizes feature sheave grooves suited for a range of wire line diameters.
- Meets or exceeds all requirements of ASME B30.26 including identification ductility, design factor, proof load and temperature requirements.
- Meet other critical performance requirements including fatigue life and material traceability, not addressed by ASME B30.26.

... [Read more](#)

**Material:** Forged steel.

**Marking:** CE-marked

## Snatch Block McKissick 421 with Shackle - Champion

### Blueprint

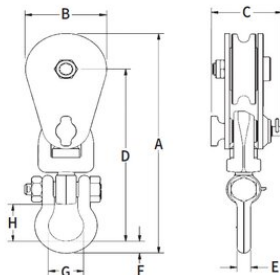

### Technical data

Part code	Rope Ø range mm	WLL (metric) tonnes	Sheave dia mm	Bearing	A in	B in	C in	D in	E in	F in	G, in	H, in	Weight
424101500140	19-22	15	203	BB	22.99	8.11	5.08	17.2	1.5	1.73	3.11	3.11	26.8
424101500145	19-22	15	203	RB	22.99	8.11	5.08	17.2	1.5	1.73	3.11	3.11	26.8
424101500146	19-22	15	254	BB	24.76	10.12	5.08	17.95	1.5	1.73	3.11	3.11	30.8
424101500147	19-22	15	254	RB	24.76	10.12	5.08	17.95	1.5	1.73	3.11	3.11	30.8