

Snatch Block McKissick 419 with Shackle - Light Champion

Product information



The McKissick snatch block 419 Light Champion from Crosby is a snatch block fitted with a shackle. Available from WLL 2 tons up to 15 tons. Can be delivered with bronze bushing (BB) and from WLL 8 T also with roller bearing (RB).

Features:

- Bolt for opening feature is retained, to ensure no lost bolts.
- Opening feature permits easy insertion of rope without reeving, or while the block is suspended.
- Center pin equipped with pressure lube fitting.
- All sizes feature sheave grooves suited for a range of wire line diameters.
- Meets or exceeds all requirements of ASME B30.26 including identification ductility, design factor, proof load and temperature requirements.
- Meet other critical performance requirements including fatigue life and material traceability, not addressed by ASME B30.26.

[... Read more](#)

Material: Forged steel.

Marking: CE-marked

Safety factor: 4:1

Snatch Block McKissick 419 with Shackle - Light Champion

Blueprint

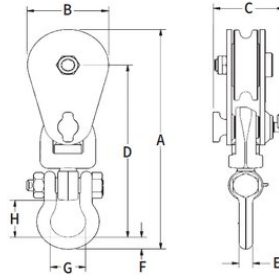

Technical data

Part code	Code	Rope Ø range mm	WLL (metric) tonnes	Sheave dia mm	Bearing	A in	B in	C in	D, in	E in	F in	G, in	H, in	Weight lb
424100200200	419 w/eye	8-10	2	76	BB	8.66	2.99	2.64	6.61	0.55	0.55	1.38	1.38	3.97
424100200205	419	8-10	2	76	BB	9.25	2.99	2.64	7.28	0.51	0.51	1.34	1.57	5.07
424100400200	419	10-13	4	114	BB	13.39	4.25	3.11	10.55	0.63	0.71	1.69	2.01	11.9
424100800200	419	16-19	8	152	BB	18.94	5.98	4.17	14.69	1.26	1.26	2.99	3.46	28
424100800205	419	16-19	8	152	RB	18.94	5.98	4.17	14.69	1.26	1.26	2.99	3.46	28
424100800206	419	16-19	8	203	BB	20.98	8.11	4.17	15.67	1.26	1.26	2.99	3.46	33.07
424100800207	419	16-19	8	203	RB	20.98	8.11	4.17	15.67	1.26	1.26	2.99	3.46	33.07
424100800208	419	16-19	8	254	BB	23.07	10.12	4.17	16.73	1.26	1.26	2.99	3.46	42.99
424100800209	419	16-19	8	254	RB	23.07	10.12	4.17	16.73	1.26	1.26	2.99	3.46	42.99
424100800201	419	16-19	8	305	BB	25.87	12.13	4.17	18.54	1.26	1.26	2.99	3.46	54.9
424100800204	419	16-19	8	305	RB	25.87	12.13	4.17	18.54	1.26	1.26	2.99	3.46	54.9
424100800203	419	16-19	8	356	BB	27.36	14.13	4.17	19.06	1.26	1.26	2.99	3.46	67.02
4241008002013	419	16-19	8	356	RB	27.36	14.13	4.17	19.06	1.26	1.26	2.99	3.46	67.02
424101500200	419	19-22	15	406	BB	31.73	16.1	5.08	22.01	1.5	1.73	3.11	3.11	130.07
424101500205	419	19-22	15	406	RB	31.73	16.1	5.08	22.01	1.5	1.73	3.11	3.11	130.07
424101500206	419	22-26	15	457	BB	33.11	18.11	5.08	22.24	1.5	1.73	3.11	3.11	158.95
424101500207	419	22-26	15	457	RB	33.11	18.11	5.08	22.24	1.5	1.73	3.11	3.11	158.95