

Snatch Block Green Pin® type 601H P-6952

Product information



The Green Pin® Snatch Block HK is a light-weight snatch block type 601HK with a hook attached. The snatch block has a smooth, uninterrupted pull due to the conical roller bearings. The coating of the Green Pin® Snatch Block HK ensures long-term durability, even under harsh conditions. It is available in a range with a working load limit from 2 up to 15 ton.

Certification on request: 2.1, 2.2, MTCb

... [Read more](#)

Material: Carbon steel, fitted with conical roller bearings

Marking: CE-marked

Finish: Painted

Note: WLL is on the headfitting

Safety factor: 4:1

Snatch Block Green Pin® type 601H P-6952

Blueprint

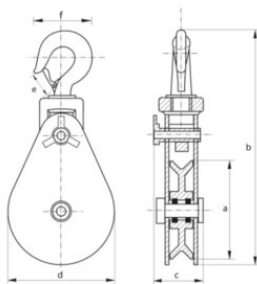

Snatch Block Green Pin® type 601H P-6952

Technical data

| Part code | Rope Ø range mm | WLL (metric) tonnes | Sheave dia mm | a in | b mm in | c in | dmm in | e mm in | f mm in | Weight lb |
|-----------------|-----------------|---------------------|---------------|-------|---------|------|--------|---------|---------|-----------|
| 4241BKOFFSH0302 | 7-9 | 2 | 75 | 2.95 | 11.42 | 3.43 | 3.23 | 1.1 | 4.25 | 8.11 |
| 4241BKOFFSH0404 | 10-12 | 4 | 115 | 4.53 | 14.09 | 3.5 | 4.72 | 1.69 | 4.92 | 13.23 |
| 4241BKOFFSH0804 | 10-12 | 4 | 200 | 7.87 | 18.62 | 3.58 | 8.27 | 1.57 | 4.92 | 17.64 |
| 4241BKOFFSH0604 | 12-14 | 4 | 150 | 5.91 | 16.22 | 3.5 | 6.3 | 1.57 | 4.92 | 18.74 |
| 4241BKOFFSH0608 | 20-22 | 8 | 150 | 5.91 | 19.76 | 4.69 | 6.3 | 1.89 | 6.5 | 26.01 |
| 4241BKOFFSH0808 | 20-22 | 8 | 200 | 7.87 | 21.69 | 4.69 | 8.27 | 1.89 | 6.5 | 44.97 |
| 4241BKOFFSH1008 | 20-22 | 8 | 250 | 9.84 | 23.86 | 4.06 | 10.24 | 1.81 | 6.5 | 56 |
| 4241BKOFFSH1208 | 20-22 | 8 | 300 | 11.81 | 26.42 | 4.69 | 12.2 | 1.81 | 6.5 | 70.55 |
| 4241BKOFFSH1408 | 20-22 | 8 | 350 | 13.78 | 28.19 | 4.69 | 14.17 | 1.81 | 6.5 | 83.78 |
| 4241BKOFFSH1608 | 20-22 | 8 | 400 | 15.75 | 30.71 | 4.69 | 16.34 | 1.81 | 6.5 | 105.82 |
| 4241BKOFFSH1808 | 20-22 | 8 | 450 | 17.72 | 33.11 | 4.69 | 18.31 | 1.81 | 6.5 | 127.87 |
| 4241BKOFFSH0612 | 20-22 | 12 | 152 | 5.91 | 24.25 | 4.69 | 6.3 | 2.76 | 9.29 | 45.19 |
| 4241BKOFFSH0812 | 20-22 | 12 | 200 | 7.87 | 25.24 | 5.08 | 8.27 | 2.76 | 9.29 | 66.14 |
| 4241BKOFFSH1012 | 20-22 | 12 | 250 | 9.84 | 28.66 | 4.92 | 10.24 | 2.76 | 9.29 | 78.26 |
| 4241BKOFFSH1612 | 20-22 | 12 | 400 | 15.75 | 34.96 | 6.54 | 16.34 | 2.76 | 9.29 | 79.37 |
| 4241BKOFFSH1812 | 20-22 | 12 | 450 | 17.72 | 37.09 | 6.54 | 18.31 | 2.76 | 9.29 | 92.59 |
| 4241BKOFFSH1212 | 20-22 | 12 | 300 | 11.81 | 31.89 | 6.54 | 12.2 | 2.76 | 9.29 | 110.23 |
| 4241BKOFFSH1412 | 20-22 | 12 | 350 | 13.78 | 32.87 | 6.54 | 14.17 | 2.76 | 9.29 | 130.07 |
| 4241BKOFFSH0615 | 24-26 | 15 | 150 | 5.91 | 24.65 | 5.43 | 6.3 | 2.76 | 9.29 | 51.81 |
| 4241BKOFFSH0815 | 24-26 | 15 | 200 | 7.87 | 26.1 | 5.59 | 8.27 | 2.76 | 9.29 | 65.04 |
| 4241BKOFFSH1015 | 24-26 | 15 | 250 | 9.84 | 29.33 | 6.54 | 10.24 | 2.76 | 9.29 | 90.39 |
| 4241BKOFFSH1215 | 24-26 | 15 | 300 | 11.81 | 31.89 | 6.54 | 12.2 | 2.76 | 9.29 | 114.64 |
| 4241BKOFFSH1415 | 24-26 | 15 | 350 | 13.78 | 32.95 | 6.54 | 14.17 | 2.76 | 9.29 | 128.97 |
| 4241BKOFFSH1615 | 24-26 | 15 | 400 | 15.75 | 35.04 | 6.54 | 16.34 | 2.76 | 9.29 | 151.02 |
| 4241BKOFFSH1815 | 24-26 | 15 | 450 | 17.72 | 37.09 | 6.54 | 18.31 | 2.76 | 9.29 | 180.78 |