

## Connecting Link Green Pin Tycan® UMJT

### Product information



The Green Pin Tycan® Connecting Link GR10 is used for connecting Green Pin Tycan® chain slings. The Connecting Link is made from grade 10, high tensile steel and is available in a range with a working load limit from 2.6 ton up to 10.3 ton and a lashing capacity of 10 and 13.6 ton. Spare bushes for the connecting link are also available separately.

Certification on request: 2.1, 2.2, 3.1, MTCa, MPIb

[... Read more](#)

**Material:** Alloy steel

**Marking:** According to standard, Manufacturer ID, chain diameter, traceability code, steel grade, item code and origin

**Temperature range:** -40°C up to +200°C

**Finish:** Blue painted

**Standard:** EN 1677-1

**Safety factor:** 4:1

**Grade:** 10

## Connecting Link Green Pin Tycan® UMJT

### Blueprint

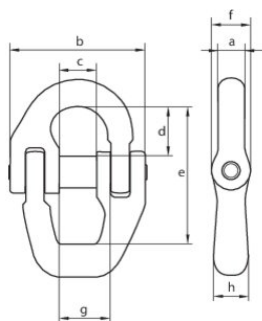

### Technical data

Part code	WLL (metric) tonnes	LC kN	For chain Ø mm	a in	b mm in	c in	d mm in	e mm in	f mm in	g mm in	h mm in	Weight lb
402200260220	2.6	54	11x15	0.35	2.24	0.55	0.79	2.17	0.63	0.75	0.51	0.49
402200400220	4	80	11x20	0.47	2.6	0.71	0.91	2.52	0.71	0.91	0.63	0.82
402200680220	6.8	136	13x30	0.63	3.27	0.83	1.26	3.35	0.94	1.1	0.79	1.72
402201030220	10.3	206	-	0.75	4.06	1	1.57	4.23	1.1	1.34	0.94	3.22