

## Web Sling Shackle SC Green Pin® P-5461

### Product information



The Green Pin® Web Sling Shackle SC is the ideal shackle for lifting with synthetic round and flat web slings. The optimal bearing surface of the shackle crown means the load on the web sling is distributed evenly. As a result, damage to the web sling is minimized and its lifespan extended. Wear of the web sling is also minimized as a result of the smooth finish of the shackle. Furthermore, because the load is distributed evenly on the web sling compared to a standard shackle, it is not necessary to reduce the load (WLL) on the web sling. The risk of damage to the web sling that touches the pin is also significantly reduced because the screw thread is completely hidden into the shackle eye. The product is suitable for web slings made according to EU and US standards. The shackle is available in a range with a working load limit from 3.25 up to 8.5 ton.

Certification on request: 2.1, 2.2, 3.1

... [Read more](#)

**Material:** Alloy steel, quenched and tempered

**Marking:** According to standard, CE-marked

**Temperature range:** -40°C up to +200°C

**Finish:** Painted green

**Standard:** EN 1677-1

**Safety factor:** 6:1

**Grade:** 8

## Web Sling Shackle SC Green Pin® P-5461

### Blueprint

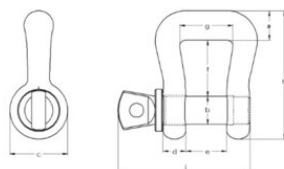

### Technical data

Part code	WLL (metric) tonnes	a in	b mm in	c in	d mm in	e mm in	f mm in	g mm in	h mm in	i mm in	j mm in	Weight lb
420100332340	3.25	0.79	0.75	1.57	0.63	1.06	1.5	1.38	3.43	3.5	2.68	1.46
420100482340	4.75	0.94	0.87	1.81	0.75	1.22	1.89	1.81	4.17	4.06	3.35	2.43
420100652340	6.5	1.06	0.98	2.05	0.87	1.42	2.83	2.44	5.41	4.69	4.27	3.95
420100852340	8.5	1.22	1.1	2.32	0.98	1.69	3.29	3.11	6.22	5.39	5.26	6.04