

Dee Shackle with Screw Pin R-7821, Stainless Steel

Product information



Stainless steel dee shackle with screw pin.

Certification on request: 2.1, 2.2, 3.1

Standard: Generally to DIN 82102.

... [Read more](#)

Material: AISI 316

Marking: CE-marked

Finish: Polished

Note: WLL, manufacturer identification symbol (VBS), except for 4 mm as it is too small.

Dee Shackle with Screw Pin R-7821, Stainless Steel

Blueprint

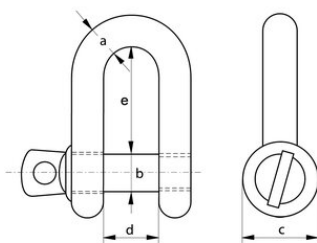

Technical data

Part code	WLL (metric)	a in	b mm in	c in	dmm in	e mm in	Weight
420100012780	0.12	0.2	0.2	0.39	0.39	0.79	0.016
420100022780	0.15	0.24	0.24	0.47	0.47	0.94	0.026
420100032780	0.3	0.31	0.31	0.63	0.63	1.26	0.056
420100042780	0.4	0.39	0.39	0.79	0.79	1.57	0.13
420100062780	0.6	0.47	0.47	0.94	0.94	1.89	0.2
420100102780	1	0.63	0.63	1.26	1.26	2.52	0.48
420100152780	1.5	0.79	0.79	1.57	1.57	3.15	0.78
420100202780	2	0.87	0.87	1.73	1.73	3.46	1.27
420100302780	3	0.98	0.98	1.97	1.97	3.94	1.84
420100362780	3.6	1.1	1.1	2.13	2.2	4.17	2.5
420100002780	-	0.16	0.16	0.31	0.31	0.63	0.009