

## Bow Shackle with Safety Bolt R-7827, Stainless Steel

---

### Product information

Stainless steel bow shackle with safety bolt.

Certification on request: 2.1, 2.2, 3.1

**Standard:** Generally to DIN 82103.

... [Read more](#)

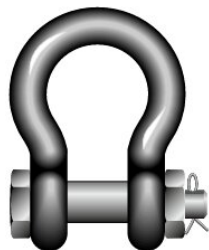

**Material:** AISI 316

**Marking:** According to standard, CE-marked

**Finish:** polished

**Standard:** EN 13889

**Note:** WLL, traceability code and manufacturer identification symbol (VBS)

**Safety factor:** 6:1

## Bow Shackle with Safety Bolt R-7827, Stainless Steel

### Blueprint

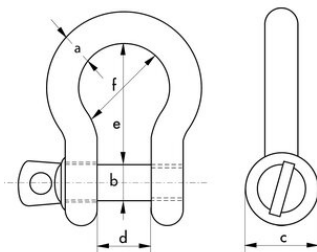

### Technical data

Part code	WLL (metric) tonnes	a in	b mm in	c in	dmm in	e mm in	f mm in	Weight lb
420100030620	0.3	0.31	0.31	0.63	0.63	1.26	0.94	16.31
420100040620	0.4	0.39	0.39	0.75	0.79	1.57	1.18	31.97
420100060620	0.6	0.47	0.47	0.94	0.98	1.93	1.42	50.71
420100100620	1	0.63	0.63	1.22	1.26	2.52	1.89	124.78
420100150620	1.5	0.75	0.75	1.5	1.5	3.15	2.36	219.36
420100200620	2	0.87	0.87	1.69	1.73	3.35	2.6	321.88
420100300620	3	0.98	0.98	1.93	1.97	3.94	2.95	480.61