

Bow Shackle BN Green Pin Super® G-5263

Product information

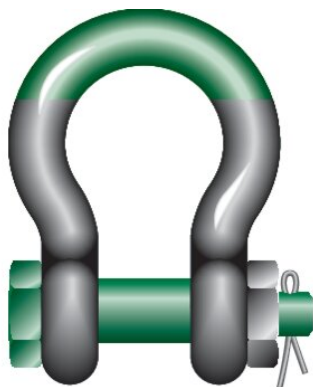

The Green Pin Super® Bow Shackle BN is a grade 8 bow shackle with a safety bolt. Handling of the Green Pin Super® Bow Shackle BN is easier due to the smaller size and weight (with an equal working load limit when compared to non-Super products). The shackle also offers a double safety (split pin and safety bolt) which prevents accidental unscrewing of the pin. Furthermore, the long-term durability of the shackle is assured as a result of its galvanization. Wear and tear of the counter components such as wire rope is also minimized as the chamber in the shackle eye hides the screw thread. The Green Pin Super® Bow Shackle BN is available in a range with a working load limit from 3.3 up to 175t

Certification on request: 2.1, 2.2, 3.1, MTCa, MTCb, LROS, ABS PDA, ARS MA
... [Read more](#)

Material: Bow and pin alloy steel, quenched and tempered

Marking: CE-marked

Temperature range: -20°C up to +200°C

Finish: Hot dipped galvanized (150 ton and upward are painted)

Note: Shackles with WLL 150 ton and 175 ton have a round headed bolt

Safety factor: 5:1

Grade: 8

Bow Shackle BN Green Pin Super® G-5263

Blueprint

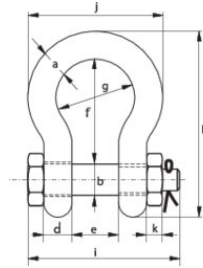

Technical data

Part code	WLL (metric) tonnes	a in	b mm in	c in	d mm in	e mm in	f mm in	g mm in	h mm in	i mm in	j mm in	k mm in	Weight lb
420100330590	3.3	0.53	0.63	1.34	0.51	0.87	2.01	1.26	3.54	3.15	2.32	0.51	0.88
420100500590	5	0.63	0.75	1.57	0.63	1.06	2.52	1.69	4.33	3.86	2.95	0.67	1.61
420100700590	7	0.75	0.87	1.81	0.75	1.22	2.99	2.01	5.08	4.53	3.5	0.75	2.62
420100950590	9.5	0.87	0.98	2.05	0.87	1.42	3.27	2.28	5.67	5.12	4.02	0.87	3.81
420101250590	12.5	0.98	1.1	2.32	0.98	1.69	3.74	2.68	6.46	5.91	4.65	0.98	5.64
420101500590	15	1.1	1.26	2.64	1.1	1.85	4.25	2.95	7.32	6.54	5.16	1.06	7.94
420101800590	18	1.26	1.38	2.87	1.26	2.01	4.53	3.27	7.91	7.24	5.79	1.18	10.91
420102100590	21	1.38	1.5	3.11	1.38	2.24	5.24	3.62	8.94	7.76	6.38	1.3	14.59
420103000590	30	1.5	1.65	3.46	1.5	2.36	5.75	3.9	9.8	7.95	6.89	0.75	17.88
420104000590	40	1.77	1.97	4.09	1.77	2.91	7.01	4.96	11.81	9.57	8.5	0.91	32.63
420105500590	55	2.24	2.24	4.69	2.24	3.27	7.76	5.43	13.46	11.14	9.92	1.02	51.37
420108500590	85	2.76	2.76	5.71	2.76	4.13	10.24	7.09	17.24	13.35	12.6	1.26	99.43
420112000590	120	3.27	3.27	6.46	3.27	5	12.95	7.48	21.14	15.63	14.02	1.54	158.73
420115000590	150	3.74	3.74	8.03	3.74	5.79	15.75	9.37	25.35	17.83	16.85	1.97	255.74
420117500590	175	4.13	4.25	9.25	4.13	6.65	16.14	10.83	27.01	19.53	19.09	1.97	343.92