

Bow Shackle BN Green Pin BigMouth® G-4263

Product information

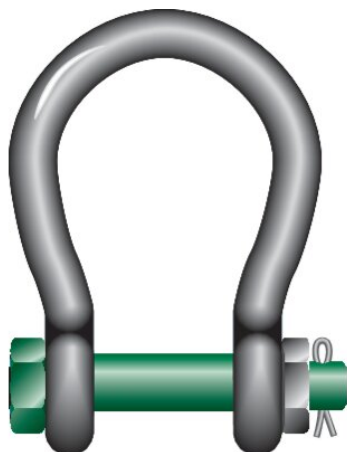

The Green Pin BigMouth® Bow Shackle BN is a grade 8 shackle with a safety bolt and a wider shackle mouth. The wider shackle mouth enables you to connect the shackle to a connecting point (e.g. a pad eye) which is wider than usual. The shackle also offers a double safety (split pin and safety bolt) which prevents accidental unscrewing of the pin. Long-term durability is assured due to the galvanization of the Green Pin BigMouth® Bow Shackle BN. Of course, the Green Pin BigMouth® Bow Shackle BN conforms to a range of certifications. The shackle is suitable for both one-leg and multi-leg systems and is available in a range with a working load limit from 4.75 up to 75 ton.

Certification on request: 2.1, 2.2, 3.1, MTCa

[... Read more](#)

Material: Bow and pin alloy steel, quenched and tempered

Marking: CE-marked

Temperature range: -20°C up to +200°C

Finish: Hot dip galvanized

Safety factor: 6:1

Grade: 8

Bow Shackle BN Green Pin BigMouth® G-4263

Blueprint

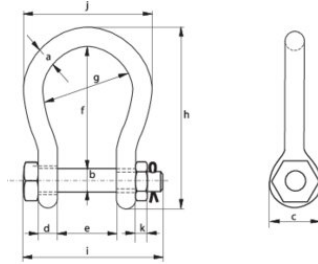

Technical data

Part code	WLL (metric) tonnes	A in	B in	C in	D in	e mm in	f mm in	g mm in	h mm in	i mm in	j mm in	k mm in	Weight lb
420100481020	4.75	0.87	0.98	2.05	0.87	2.48	4.41	3.46	6.81	6.18	5.2	0.91	4.59
420100651020	6.5	0.98	1.1	2.32	0.98	2.95	5.31	4.13	8.03	7.2	6.1	0.98	6.92
420100851020	8.5	1.1	1.26	2.6	1.1	3.23	5.83	4.53	8.86	8.07	6.73	1.06	9.61
420100951020	9.5	1.26	1.38	2.83	1.26	3.54	6.38	4.96	9.76	8.82	7.48	1.18	13.12
420101201020	12	1.38	1.5	3.11	1.38	3.94	7.09	5.51	10.79	9.65	8.27	1.3	17.35
420101601020	16	1.5	1.65	3.46	1.5	4.17	8.5	6.26	12.56	9.76	9.25	0.75	27.56
420102501020	25	1.77	1.97	4.06	1.77	5	9.76	6.89	14.57	11.65	10.43	0.91	36.82
420103001020	30	1.97	2.24	4.65	1.97	5.75	10.75	8.15	16.18	13.07	12.09	1.02	55.12
420105501020	55	2.56	2.76	5.71	2.56	6.5	12.36	8.39	19.17	15.39	13.5	1.26	99.21
420107501020	75	3.27	3.27	6.46	3.27	7.24	12.99	10	21.14	18.11	16.54	1.54	154.32