

Bow Shackles BN Van Beest Green Pin® G-4163

Product information

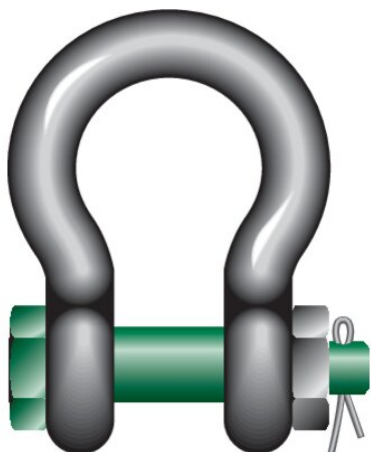

The Green Pin® Bow Shackle BN is a bow shackle with a safety bolt. The shackle offers a double safety (split pin and safety bolt) which prevents accidental unscrewing of the pin. Long-term durability is assured due to the galvanization of the Green Pin® Bow Shackle BN. Of course, the Green Pin® Bow Shackle BN conforms to a wide range of certifications from class societies such as DNV GL. The Green Pin® Bow Shackle BN is suitable for both one-leg and multi-leg systems and is available in a range with a working load limit from 0.5 up to 85 ton.

Certification on request: 2.1, 2.2, 3.1, MTCa, DNV 2.7-1a, DNV 2.7-1b, DNVGL-ST-0378, ABS PDA, ABS MA

... [Read more](#)

Material: Bow and pin high tensile steel, quenched and tempered

Marking: According to standard, CE-marked

Temperature range: -40°C up to +200°C

Finish: Hot dip galvanized

Standard: EN 13889

Safety factor: 6:1

Grade: 6

Bow Shackles BN Van Beest Green Pin® G-4163

Blueprint

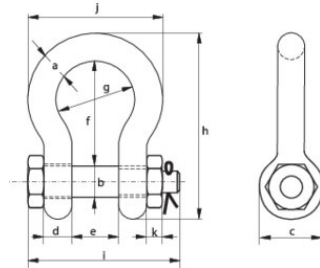

Technical data

Part code	WLL (metric) tonnes	a in	b mm in	c in	d mm in	e mm in	f mm in	g mm in	h mm in	i mm in	j mm in	k mm in	Weight lb
420100050570	0.5	0.28	0.31	0.63	0.28	0.47	1.14	0.79	1.89	1.65	1.34	0.16	0.13
420100080570	0.75	0.35	0.39	0.79	0.35	0.51	1.26	0.87	2.2	1.97	1.57	0.2	0.24
420100100570	1	0.39	0.43	0.87	0.39	0.67	1.42	1.02	2.48	2.36	1.81	0.31	0.35
420100150570	1.5	0.43	0.51	1.02	0.43	0.75	1.69	1.14	2.91	2.64	2.01	0.43	0.49
420100200570	2	0.51	0.63	1.34	0.51	0.87	2.01	1.26	3.5	3.23	2.28	0.51	0.93
420100330570	3.25	0.63	0.75	1.57	0.63	1.06	2.52	1.69	4.33	3.86	2.95	0.67	1.63
420100480570	4.75	0.75	0.87	1.81	0.75	1.22	2.99	2.01	5.08	4.49	3.5	0.75	2.6
420100650570	6.5	0.87	0.98	2.05	0.87	1.42	3.27	2.28	5.67	5.12	4.02	0.87	3.9
420100850570	8.5	0.98	1.1	2.32	0.98	1.69	3.74	2.68	6.46	5.91	4.65	0.98	5.69
420100950570	9.5	1.1	1.26	2.6	1.1	1.85	4.25	2.95	7.28	6.54	5.16	1.06	8.07
420101200570	12	1.26	1.38	2.83	1.26	2.01	4.53	3.27	7.91	7.01	5.79	1.18	10.82
420101350570	13.5	1.38	1.5	3.15	1.38	2.24	5.24	3.62	8.94	7.76	6.38	1.3	14.42
420101700570	17	1.5	1.65	3.46	1.5	2.36	5.75	3.9	9.8	7.95	6.89	0.75	18.06
420102500570	25	1.77	1.97	4.06	1.77	2.91	7.01	4.96	11.81	9.8	8.5	0.91	31.35
420103500570	35	1.97	2.24	4.37	1.97	3.27	7.76	5.43	13.03	10.59	9.37	1.02	43.76
420104250570	42.5	2.24	2.56	5.12	2.24	3.74	8.74	6.3	14.84	11.85	10.79	1.14	62.46
420105500570	55	2.56	2.76	5.71	2.56	4.13	10.24	7.09	17.05	12.99	12.2	1.26	87.28
420108500570	85	2.95	3.27	6.38	2.87	5	12.95	7.48	20.75	14.96	13.39	1.54	136.69