

## Dee Shackle SC Green Pin® Pin G-4151

### Product information



The Green Pin® Dee Shackle SC is a dee shackle with a screw collar pin. The screw pin enables quick (dis)assembly which makes the shackle perfect for rigging activities in which assembly and disassembly occur relatively frequently. Due to the galvanization of the shackle its long-term durability is assured. Furthermore, the shackle's design reduces the wear of (wire) rope as the screw thread is hidden in a chamber. Particularly important for use offshore, the Green Pin® Dee Shackle SC conforms to a wide range of certifications from class societies such as DNV GL. The Green Pin® Dee Shackle SC is suitable for one-leg lifting systems only and is available in a range with a working load limit from 0.33 up to 55 ton.

Certification on request: 2.1, 2.2, 3.1, MTCa, DNVGL-ST-0378, ABS PDA ARS MA  
... [Read more](#)

**Material:** Bow and pin high tensile steel, quenched and tempered

**Marking:** According to standard, CE-marked

**Temperature range:** -40°C up to +200°C

**Finish:** Hot dip galvanized

**Standard:** EN 13889

**Safety factor:** 6:1

**Grade:** 6

## Dee Shackle SC Green Pin® Pin G-4151

### Blueprint

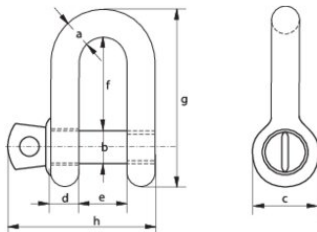

### Technical data

Part code	WLL (metric) tonnes	A in	B in	C in	D, in	e mm in	f mm in	g mm in	h mm in	Weight lb
420100030680	0.33	0.2	0.24	0.47	0.2	0.35	0.75	1.3	1.14	0.04
420100050680	0.5	0.28	0.31	0.63	0.28	0.47	0.87	1.61	1.5	0.11
420100080680	0.75	0.35	0.39	0.79	0.35	0.51	1.02	1.97	1.81	0.2
420100100680	1	0.39	0.43	0.87	0.39	0.67	1.26	2.32	2.13	0.31
420100150680	1.5	0.43	0.51	1.02	0.43	0.75	1.46	2.68	2.32	0.42
420100200680	2	0.51	0.63	1.34	0.51	0.87	1.69	3.19	2.87	0.71
420100330680	3.25	0.63	0.75	1.57	0.63	1.06	2.01	3.82	3.5	1.19
420100480680	4.75	0.75	0.87	1.81	0.75	1.22	2.32	4.41	4.06	1.92
420100650680	6.5	0.87	0.98	2.05	0.87	1.42	2.87	5.28	4.69	2.95
420100850680	8.5	0.98	1.1	2.32	0.98	1.69	3.35	6.06	5.39	4.59
420100950680	9.5	1.1	1.26	2.6	1.1	1.85	3.54	6.57	6.02	6.11
420101200680	12	1.26	1.38	2.83	1.26	2.01	3.7	7.09	6.69	8.2
420101350680	13.5	1.38	1.5	3.15	1.38	2.24	4.53	8.23	7.32	11.33
420101700680	17	1.5	1.65	3.46	1.5	2.36	5	9.06	7.99	15.1
420102500680	25	1.77	1.97	4.06	1.77	2.91	5.87	10.67	9.57	25.24
420103500680	35	1.97	2.24	4.37	1.97	3.27	6.73	12.01	10.71	37.17
420104250680	42.5	2.24	2.56	5.12	2.24	3.74	7.48	13.58	12.2	54.26
420105500680	55	2.56	2.76	5.71	2.56	4.13	7.99	14.8	13.54	71.98