

Bow Shackles with Safety Bolt and Fixed Nut G-4143

Product information

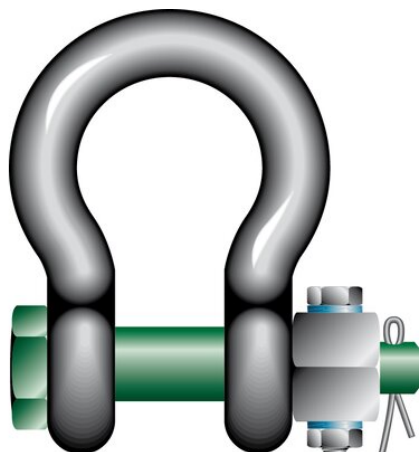

Fixed nut standard shackles, bow shackles with safety bolt and fixed nut

Certificaton: The bow shackles with safety bolt can be supplied with a works certificate, 3.1 material certificate, manufacturer test certificate, EC Declaration of Conformity. All shackles starting from 2 t can be supplied with DNV 2.7-1 certificate.

Note: Green Pin® Standard, Polar and Super shackles can be equipped with an extra AISI 316 securing bolt which is drilled through the nut and shackle pin. This securing bolt is fastened with two sets of Nord-Lock® washers and a securing nut. This will keep the shackle nut in position. The Nord-Lock wedge-locking washers lock when subjected to extreme vibration or dynamic loads.

Standard: EN 13889 and meets the performance requirements of US fed. Spec RR-C-271 Type IVA Class 3, Grade A from 2 t and upward these shackles comply with ASME B30.26

... [Read more](#)

Material: Bow and pin high tensile steel, quenched and tempered

Marking: According to standard, CE-marked

Temperature range: -40°C up to +200°C

Finish: Hot dip galvanized

Standard: EN 13889

Safety factor: 6:1

Grade: 6

Bow Shackles with Safety Bolt and Fixed Nut G-4143

Blueprint

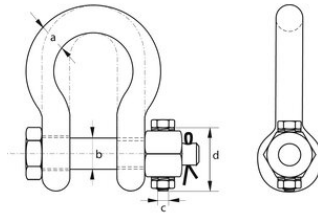

Technical data

Part code	WLL (metric) tonnes	a in	b mm in	c in	d mm in	e mm in	f mm in	g mm in	h mm in	i mm in	j mm in	k mm in	l mm mm	m mm in	Weight lb
420100200700	2	0.53	0.63	1.34	0.51	0.87	2.01	1.26	3.5	3.23	2.28	0.51	M6	1.38	0.93
420100330700	3.25	0.63	0.75	1.57	0.63	1.06	2.52	1.69	4.33	3.86	2.95	0.67	M6	1.57	1.63
420100480700	4.75	0.75	0.87	1.81	0.75	1.22	2.99	2.01	5.08	4.49	3.5	0.75	M6	1.77	2.6
420100650700	6.5	0.87	0.98	2.05	0.87	1.42	3.27	2.28	5.67	5.12	4.02	0.87	M8	1.97	3.9
420100850700	8.5	0.98	1.1	2.32	0.98	1.69	3.74	2.68	6.46	5.91	4.65	0.98	M8	2.17	5.69
420100950700	9.5	1.1	1.26	2.6	1.1	1.85	4.25	2.95	7.28	6.54	5.16	1.06	M10	2.36	8.07
420101200700	12	1.26	1.38	2.83	1.26	2.01	4.53	3.27	7.91	7.01	5.79	1.18	M10	2.56	10.58
420101350700	13.5	1.38	1.5	3.15	1.38	2.24	5.24	3.62	8.94	7.76	6.38	1.3	M10	2.76	14.42
420101700700	17	1.5	1.65	3.46	1.5	2.36	5.75	3.9	9.8	7.95	6.89	0.75	M8	2.95	18.06
420102500700	25	1.77	1.97	4.06	1.77	2.91	7.01	4.96	11.81	9.8	8.5	0.91	M8	3.54	30.86
420103500700	35	1.97	2.24	4.37	1.97	3.27	7.76	5.43	13.03	10.59	9.37	1.02	M10	3.94	43.87
420104250700	42.5	2.24	2.56	5.12	2.24	3.74	8.74	6.3	14.84	11.85	10.79	1.14	M12	4.33	62.39
420105500700	55	2.56	2.76	5.71	2.56	4.13	10.24	7.09	17.05	12.99	12.2	1.26	M12	4.72	87.3
420108500700	85	2.95	3.27	6.42	2.87	5	12.95	7.48	20.75	14.96	13.39	1.54	M12	5.51	136.69