

## Bow Shackle FN Green Pin Polar® G-5143

### Product information



The Green Pin Polar® Bow Shackle FN is a bow shackle with a safety bolt and fixed nut that has been optimized for use in low temperatures. The shackle can be used in extreme climatic conditions, down to -60°C (-76°F). The shackle is the perfect choice when the load is dynamic or exposed to extreme vibrations because of its triple safety (split pin, safety bolt and fixed nut). The fixed nut of the Green Pin Polar® Bow Shackle FN is drilled through both the shackle nut and pin and is firmly attached to the pin head with bolts and Nord-Lock® washers. Long-term durability is assured due to the galvanization of the Green Pin Polar® Bow Shackle FN. The shackle conforms to a wide range of certifications from class societies such as DNV GL. The Green Pin Polar® Bow Shackle FN is suitable for both one-leg and multi-leg systems and is available in a range with a working load limit from 2 up to 85 ton.

Certification on request: 2.1, 2.2, 3.1, MTCa, DNV 2.7-1a, DNV 2.7-1b

**Safety factor:** 7:1 up to WLL 42,5 ton. 6:1 for 55 and 85 ton.

[... Read more](#)

**Material:** Bow and pin alloy steel, quenched and tempered

**Marking:** According to standard, CE-marked

**Temperature range:** -60°F up to +200°C

**Finish:** Hot dip galvanized

**Standard:** EN 13889

**Grade:** 8

## Bow Shackle FN Green Pin Polar® G-5143

### Blueprint

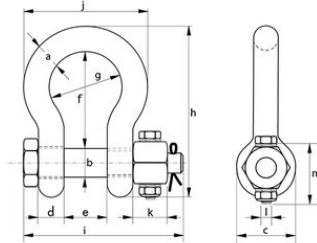

### Technical data

Part code	WLL (metric) tonnes	Torque Nm	a in	b mm in	c in	d mm in	e mm in	f mm in	g mm in	h mm in	i mm in	j mm in	k mm in	l mm mm	m mm in	Weight lb
420100200720	2	8.4	0.53	0.63	1.34	0.51	0.87	2.01	1.26	3.5	3.23	2.28	0.51	M6	1.38	0.93
420100330720	3.25	8.4	0.63	0.75	1.57	0.63	1.06	2.52	1.69	4.33	3.86	2.95	0.67	M6	1.57	1.63
420100480720	4.75	8.4	0.75	0.87	1.81	0.75	1.22	2.99	2.01	5.08	4.49	3.5	0.75	M6	1.77	2.6
420100650720	6.5	20	0.87	0.98	2.05	0.87	1.42	3.27	2.28	5.67	5.12	4.02	0.87	M8	1.97	3.9
420100850720	8.5	20	0.98	1.1	2.32	0.98	1.69	3.74	2.68	6.46	5.91	4.65	0.98	M8	2.17	5.69
420100950720	9.5	39	1.1	1.26	2.6	1.1	1.85	4.25	2.95	7.28	6.54	5.16	1.06	M10	2.36	8.07
420101200720	12	39	1.26	1.38	2.83	1.26	2.01	4.53	3.27	7.91	7.01	5.79	1.18	M10	2.56	10.82
420101350720	13.5	39	1.38	1.5	3.15	1.38	2.24	5.24	3.62	8.94	7.76	6.38	1.3	M10	2.76	14.42
420101700720	17	20	1.5	1.65	3.46	1.5	2.36	5.75	3.9	9.8	7.95	6.89	0.75	M8	2.95	18.06
420102500720	25	20	1.77	1.97	4.06	1.77	2.91	7.01	4.96	11.81	9.8	8.5	0.91	M8	3.54	31.31
420103500720	35	39	1.97	2.24	4.57	1.97	3.27	7.76	5.43	13.15	10.59	9.37	1.02	M10	3.94	43.87
420104250720	42.5	68	2.24	2.56	5.12	2.24	3.74	8.74	6.3	14.84	11.85	10.79	1.14	M12	4.33	62.39
420105500720	55	68	2.56	2.76	5.71	2.56	4.13	10.24	7.09	17.05	12.99	12.2	1.26	M12	4.72	87.3
420108500720	85	68	2.95	3.27	6.38	2.87	5	12.95	7.48	20.75	14.96	13.39	1.57	M12	5.51	136.69