

Super Bow Shackles with Safety Bolt and Fixed Nut G-5243

Product information



The Green Pin Super[®] Bow Shackle FN is a grade 8 bow shackle with a safety bolt and a fixed nut. Handling of the Green Pin Super[®] Bow Shackle FN is easier due to the smaller size and weight (with equal WLL compared to non-Super products). The shackle is the perfect choice when the load is dynamic or exposed to extreme vibrations because of its triple safety (split pin, safety bolt and fixed nut). The fixed nut of the Green Pin Super[®] Bow Shackle FN is drilled through both the shackle nut and pin and is firmly attached to the pin head with bolts and Nord-Lock[®] washers. Furthermore, the long-term durability of the shackle is assured as a result of its galvanization. Wear and tear of the counter components such as wire rope is also minimized as the chamber in the shackle eye hides the screw thread. The Green Pin Super[®] Bow Shackle FN is available in a range with a working load limit from 3.3 to 175 ton.

Certification on request: 2.1, 2.2, 3.1, MTCa, MTCb, LROS

[... Read more](#)

Material: Bow and pin alloy steel, quenched and tempered

Marking: CE-marked

Temperature range: -20°C up to +200°C

Finish: Hot dipped galvanized (150 ton and upward are painted)

Safety factor: 5:1

Grade: 8

Super Bow Shackles with Safety Bolt and Fixed Nut G-5243

Blueprint

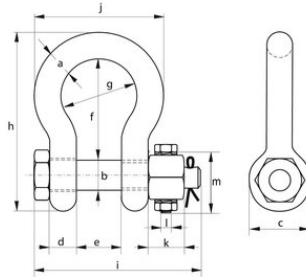

Technical data

Part code	WLL (metric) tonnes	Torque Nm	a in	b mm in	c in	d mm in	e mm in	f mm in	g mm in	h mm in	i mm in	j mm in	k mm in	l mm mm	m mm in	Weight lb
420100330710	3.3	8.4	0.53	0.63	1.34	0.51	0.87	2.01	1.26	3.5	3.23	2.28	0.51	M6	1.38	0.88
420100500710	5	8.4	0.63	0.75	1.57	0.63	1.06	2.52	1.69	4.33	3.86	2.95	0.67	M6	1.57	1.61
420100700710	7	8.4	0.75	0.87	1.81	0.75	1.22	2.99	2.01	5.08	4.49	3.5	0.75	M6	1.77	2.62
420100950710	9.5	20	0.87	0.98	2.05	0.87	1.42	3.27	2.28	5.67	5.12	4.02	0.87	M8	1.97	3.81
420101250710	12.5	20	0.98	1.1	2.32	0.98	1.69	3.74	2.68	6.46	5.91	4.65	0.98	M8	2.17	5.64
420101500710	15	39	1.1	1.26	2.6	1.1	1.85	4.25	2.95	7.28	6.54	5.16	1.06	M10	2.36	7.94
420101800710	18	39	1.26	1.38	2.83	1.26	2.01	4.53	3.27	7.91	7.01	5.79	1.18	M10	2.56	10.91
420102100710	21	39	1.38	1.5	3.15	1.38	2.24	5.24	3.62	8.94	7.76	6.38	1.3	M10	2.76	14.59
420103000710	30	20	1.5	1.65	3.46	1.5	2.36	5.75	3.9	9.8	8.54	6.89	1.34	M8	2.95	17.88
420104000710	40	20	1.77	1.97	4.06	1.77	2.91	7.01	4.96	11.81	10.24	8.5	1.57	M8	3.54	33.07
420105500710	55	39	2.24	2.24	4.61	2.24	3.27	7.76	5.43	13.43	11.93	9.92	1.81	M10	3.94	50.71
420108500710	85	68	2.76	2.76	5.63	2.76	4.13	10.24	7.09	17.2	14.29	12.6	2.2	M12	4.72	97
420112000710	120	68	3.27	3.27	6.38	3.27	5	12.95	7.48	21.06	16.73	14.02	2.6	M12	5.51	158.73
420115000710	150	68	3.74	3.74	8.19	3.74	5.79	15.75	9.37	25.47	20.63	16.85	1.97	M12	5.91	246.92
420117500710	175	68	4.13	4.25	9.37	4.13	6.65	16.14	10.83	27.09	22.32	19.09	1.97	M12	6.3	352.74