

## Pad Eye S-264, Crosby

### Product information



- Excellent welding qualities.
- Widely used on farm machinery, trucks, steel hulled marine vessels and material handling equipment.
- Reference American Welding Society specifications for proper welding procedures.

... [Read more](#)

**Material:** Forged Steel — Quenched and Tempered.

**Warning:** Pad Eyes are designed to be attached to any structure, equipment, vehicles or machinery in which there is a need or desire for an eye, without the drilling and/or threading required for an eyebolt attachment. The normal method of attachment for pad eyes is by welding. Since Crosby cannot control the method of attachment (i.e. weld quality and size), a Working Load Limit is not provided for pad eyes.

## Pad Eye S-264, Crosby

### Blueprint

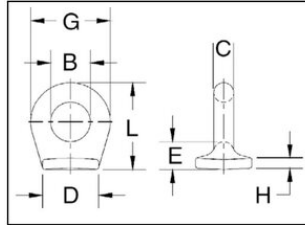

### Technical data

Size	B in	C in	D in	E in	G in	H in	L in	Weight lb
0	0.25	0.19	0.63	0.31	0.63	0.09	0.75	0.03
1	0.38	0.25	0.88	0.41	0.88	0.13	1.03	0.07
1.5	0.63	0.25	1	0.44	1.13	0.16	1.31	0.1
2	0.75	0.38	1.06	0.5	1.5	0.19	1.63	0.21
4	1	0.56	1.44	0.78	2.13	0.22	2.34	0.52
5	1.25	0.69	1.75	0.81	2.64	0.25	2.76	0.82