

Hammerlok® Coupling Links

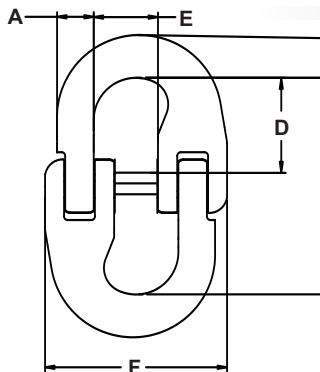

- Proven design
- Forged from Alloy Steel
- 100% proof tested
- Designed to meet ASTM A952 & EN1677

Size	Working Load Limit	Product Code	Dimensions						Weight
			A Max	B max	C	D	E Min	F	
Imperial									
in.	lb.		in.	in.	in.	in.	in.	in.	lb.
9/32	4,300	667028	0.365	0.435	1.98	0.71	0.541	1.69	0.28
3/8	8,800	667038	0.502	0.591	3.00	1.16	0.910	2.50	0.84
1/2	15,000	667050	0.678	0.780	3.80	1.43	1.097	3.19	1.87
5/8	22,600	667062	0.804	0.905	4.54	1.74	1.317	3.88	3.13
3/4	35,300	667075	0.973	1.071	5.36	2.09	1.516	4.69	5.75
Metric									
mm	kg		mm	mm	mm	mm	mm	mm	kg
7	1,950	667028	9	11	50	18	14	43	0.12
10	4,000	667038	13	15	76	29	23	64	0.38
13	6,800	667050	17	20	96	36	28	81	0.85
16	10,300	667062	20	23	115	44	33	98	1.42
20	16,000	667075	25	27	136	53	39	119	2.60

Eye Foundry Hook

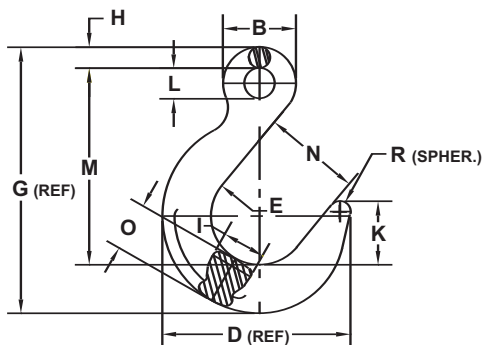

- Proven design
- Forged from Alloy Steel
- Large open throat makes attachment easy
- 100% proof tested
- Designed to meet ASTM A952 & EN1677
- For welded 7/32" chain sling use 9/32" eye hook

Size	Working Load Limit	Product Code	Dimensions											Weight	
			B	D	E	G	H	I	K	L	M	N	O		R
Imperial															
in.	lb.		in.	in.	in.	in.	in.	in.	in.	in.	in.	in.	in.	in.	lb.
9/32	4,300	474798	1.56	4.75	2.50	6.45	0.47	1.00	1.56	0.63	4.75	2.50	1.23	0.25	2.4
3/8	8,800	474799	2.00	5.75	3.00	7.88	0.63	1.27	1.88	0.75	5.75	3.00	1.50	0.31	4.5
1/2	15,000	474800	2.50	6.75	3.50	9.38	0.75	1.50	2.22	1.00	6.88	3.50	1.75	0.38	7.1
5/8	22,600	474801	3.00	7.81	4.00	10.97	0.88	1.81	2.63	1.13	8.06	4.00	2.03	0.44	11.6
3/4	35,300	474802	3.50	9.13	4.50	12.81	1.00	2.20	3.00	1.50	9.25	4.50	2.56	0.50	20.0
Metric															
mm	kg		mm	mm	mm	mm	mm	mm	mm	mm	mm	mm	mm	mm	kg
7	1,950	474798	40	121	64	164	12	25	40	16	121	64	31	6	1.09
10	4,000	474799	51	146	76	200	16	32	48	19	146	76	38	8	2.04
13	6,800	474800	64	171	89	238	19	38	56	25	175	89	44	10	3.22
16	10,300	474801	76	198	102	279	22	46	67	29	205	102	52	11	5.25
20	16,000	474802	89	232	114	325	25	56	76	38	235	114	65	13	9.06

! WARNING !
Do not exceed working load limit