

iRSi

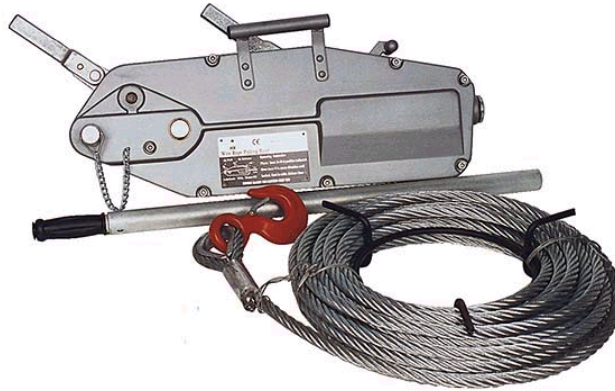

The TÜV Rheinland GS Mark has its roots in the German equipment safety law but the literal translation of "GS" does not stand for German safety, but rather "safety-tested". The safety aspects of a product are evaluated, tested and certified in conjunction with the issuance of this Marking. The TÜV Rheinland GS Mark is a voluntary test mark. It is attached to a product to highlight that a third party has tested the products safety and that a continuous production control is maintained. In the past decade, members of the European Union have become accustomed to seeing the mark on consumer Products.

The TÜV Rheinland GS Mark demonstrates the following:

- A representative sample of the product has been evaluated, tested and approved for safety.
- The production line is inspected on an annual basis.
- TÜV Rheinland GS Mark may also provide you with a marketing advantage since it is a voluntary mark.

In contrast to the TÜV Rheinland GS Mark, CE Marking is the manufacturer's self-declaration, and does not prove compliance to all applicable directives. For most products sold in the EU, the use of the CE Marking and a Declaration of Conformity are mandatory.

With the exception of some high risk products, most products can be self-declared by the manufacturer to meet the Essential Requirements. While the CE Marking does permit a product's access to the EU, it is not an approval, certification or quality mark; nor is a marketing tool. CE Marking is a "mark" that is only a declaration of the supplier's own responsibility. While enabling products to be placed on the European market, it allows for the free movement of goods and permits the withdrawal of nonconforming products.

TÜV Rheinland GS Mark vs. CE Marking

TÜV Rheinland GS Mark	CE Marking
Voluntary	Required
Only appears on approved products	Appears on all products
Proof of testing and certification through an independent third party test laboratory	Testing is assumed but not proven
Continuous product and production surveillance by independent third party for the life of the certification	Product and production surveillance is not implied or required
Valuable marketing advantage with linkage to well-known European-based test agency	No market advantage, simply a manufacturer's self declaration of conformity
TÜV Rheinland GS Mark: A symbol for safety and compliance of products	CE Marking: A symbol for trade with the assumption of conformity



Principle of Overload Protection



The principle of overload protection brake engagement is the same on both lever pullers and chain blocks. The unit has an adjustable friction disk when engaged produces a friction force between the disk and the hand wheel or lever. This is adjusted at the factory. Each unit is tested twice. The first is a normal proof load tested, and the second load is used to set the friction disk brake engagement. For example on a 1.5 ton lever block, the block is pulled to 1.5 times the WLL, 1.5 ton x 1.5 = 2.25 ton as a normal proof load test. The block is then taken to 1.3 times the WLL to set the friction brake. 1.5 ton x 1.3 = 1.95 ton. If the unit is taken above this load the friction disk will engage and the unit will not lift.

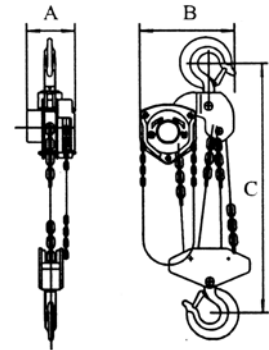
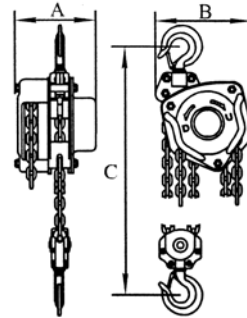
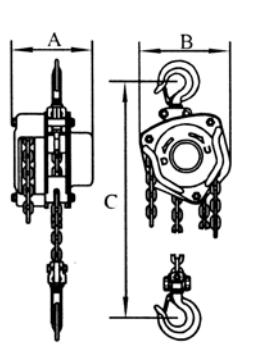

Chain Block 619

Capacity metric ton	te	0.5 te	1 te	1.5 te	2 te	3 te	5 te	10 te
Part Number		00012CH	00001CH	00112CH	00002CH	00003CH	00005CH	00010CH
3 m (10 ft) of Lift	Ea							
Part Number		0012CH20	001CH20	112CH20	002CH20	003CH20	005CH20	0010CH20
6 m (20 ft) of Lift	Ea							
Number of falls		1	1	1	1	2	2	4
Dimensions(mm)	A	131	140	161	161	161	186	207
	B	127	158	174	187	199	253	398
	C	270	317	399	414	465	636	798
	D	35	35.5	45	42.5	50	64	85
	K	30	28	36	33.5	40	50	64
Net weight	kg	10	12	19	20	27	45.5	83
Running test load	Kn	7.5	15	22.5	30	45	75	150
Effort to lift rated load	N	231	309	320	360	340	414	414
Load chain diameter	mm	6	6	8	8	8	10	10
Chain weight kg/m	kg	1.7	1.7	2.3	2.3	3.7	5.6	9.7

Standard lift stock 3 & 6 meter – “custom chain length available on request”



0.5t, 1t, 1.5t, 2t

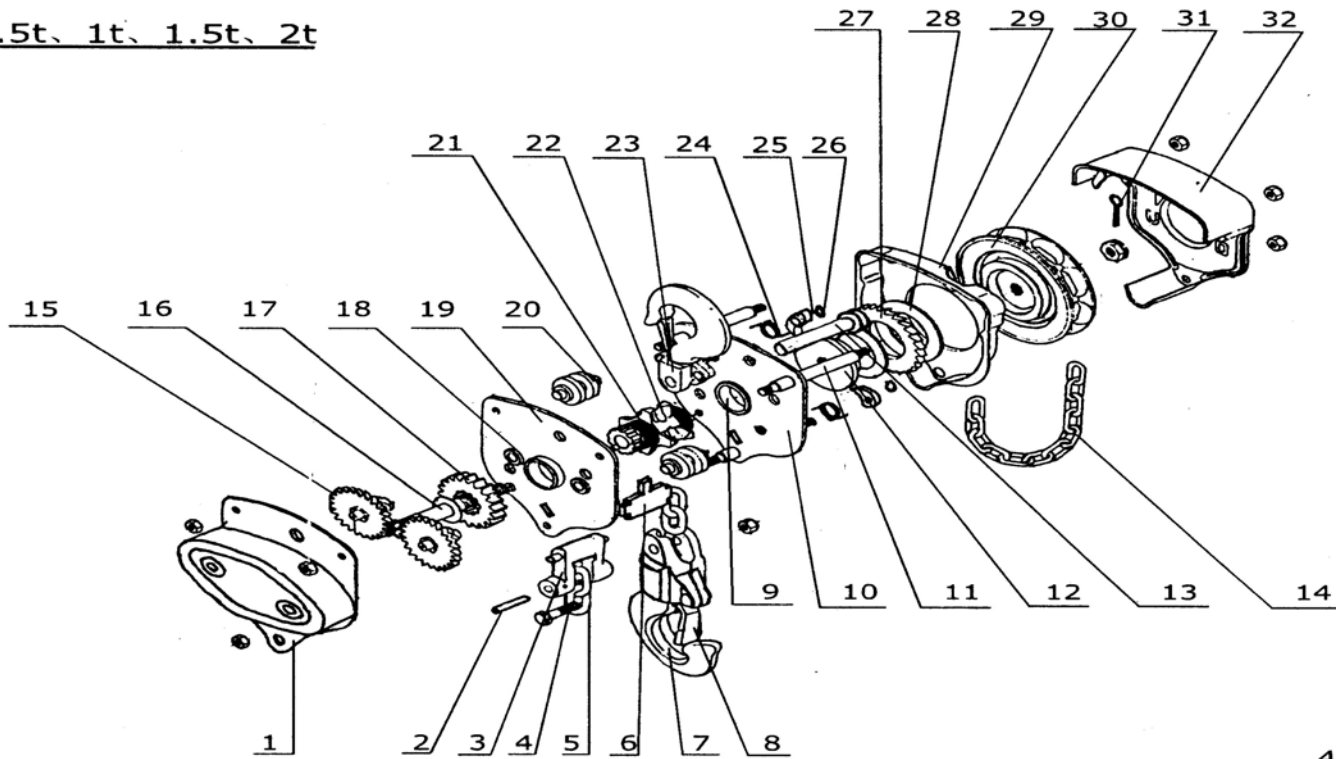

4

#	Description	#	Description	#	Description	#	Description
1	Bent plate	13	Hook pin	25	Pawl	37	Move wheel
2	End anchor pin	14	Hand chain	26	Spring ring	38	Move wheel pin
3	End anchor	15	Disk gear	27	Ratchet disk	39	Bottom hook frame
4	Chain pin	16	Driving shaft	28	Friction plate	40	Row
5	Load chain (sold/ft)	17	Splined gear	29	Brake cover	41	Hook frame bar
6	Stripper	18	Steel bushing	30	Hand wheel	42	Lock screw
7	Bottom hook as.	19	Right side plate	31	Cotter pin	43	Top hook pin
8	Safe clip	20	Guide roller	32	Hand wheel cover	44	Bunton
9	Bearing race	21	Roller	33	Hook	45	Screw
10	Left side plate	22	Load sheave	34	Spring	46	Stripper
11	Stay	23	Top hook assembly	35	Rivet	47	Sling plate
12	Brake seat	24	Double spring	36	Top hook frame	48	Bottom hook pin

Spare Parts Chain Block 619

#	Description	1/2 tonne	1 tonne	1-1/2 tonne	2 tonne	3 tonne	5 tonne	10 tonne
2	End anchor pin	6-0.5TCBEAP	6-1TCBEAP	6-1.5TCBEAP	6-2TCBEAP	6-3TCBEAP	6-5TCBEAP	6-5TCBEAP
4	Chain pin	6-0.5TCBCP	6-1TCBCP	6-1.5TCBCP	6-2TCBCP	6-3TCBCP	6-5TCBCP	6-5TCBCP
5	Load chain (\$/ft)	6-0.5-1TCBCH		6-1.5T-3TCBCH			6-5T-10TCBCH	
7	Bottom hook as.	6-0.5TCBBHA	6-1TCBBHA	6-1.5TCBBHA	6-2TCBBHA	6-3TCBBHA	6-5TCBBHA	6-10TCBBHA
8	Safe clip	6-0.5TCBSC	6-1TCBSC	6-1.5TCBSC	6-2TCBSC	6-3TCBSC	6-5TCBSC	6-10TCBSC
13	Hook pin	6-0.5TCBHP	6-1TCBHP	6-1.5TCBHP	6-2TCBHP	6-3TCBHP	6-5TCBHP	6-5TCBHP
14	Hand chain	6-HAND CHAIN						
22	Load sheave	6-0.5&1TLS		6-1.5&2TLS		6-3TLS	6-5TLS	6-5TLS
23	Top hook assem.	6-0.5TCBTHA	6-1TCBTHA	6-1.5TCBTHA	6-2TCBTHA	6-3TCBTHA	6-5TCBTHA	6-10TCBTHA
24	Double spring	6-0.5TCBDS	6-1TCBDS	6-1.5TCBDS	6-2TCBDS	6-3TCBDS	6-5TCBDS	6-5TCBDS
25	Pawl	6-0.5TCBP	6-1TCBP	6-1.5TCBP	6-2TCBP	6-3TCBP	6-5TCBP	6-5TCBP
26	Spring ring	6-0.5TCBSR	6-1TCBSR	6-1.5TCBSR	6-2TCBSR	6-3TCBSR	6-5TCBSR	6-5TCBSR
28	Friction plate	6-0.5TCBFP	6-1TCBFP	6-1.5TCBFP	6-2TCBFP	6-3TCBFP	6-5TCBFP	6-5TCBFP
31	Cotter pin	6-0.5TCBCP	6-1TTCBCP	6-1.5TCBCP	6-2TCBCP	6-3TCBCP	6-5TCBCP	6-5TCBCP

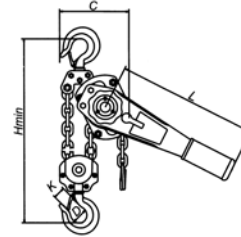
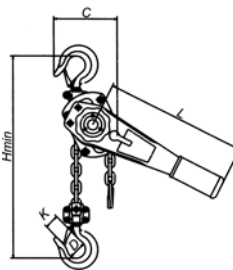
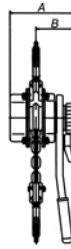

Lever Puller 622 Patented 0.75 to 3 tonne

6 tonne

Part Number		00034LP	00112LP	00003LP	00006LP	00009LP
Capacity metric tonne	te	0.75 te	1.5 te	3 te	6 te	9 te
Standard lift	m	1.5	1.5	1.5	1.5	1.5
Strands of load chain		1	1	1	2	3
Dimensions(mm)	A	148	172	200	200	200
	B	90	98	115	115	115
	C	136	160	180	235	320
	D	40	45	58	64	85
Net weight	H	325	380	480	620	700
	L	280	410	410	410	410
	K	34	38	48	52	58
	kg	7	11	21	31	46
Running test load	Kn	11.0	22.0	37.5	75.0	112.5
Force to lift rated load	N	140	220	320	340	360
Load chain diameter	mm	6	8	10	10	10
Chain weight kg/m	kg	0.8	1.4	2.2	4.4	6.6



Spare Parts Pricing - " Custom Chain Lengths available on request"

#	Description	¾ tonne	1-1/2 tonne	3 tonne	6 tonne
6	Load sheave	6-0.75TLBLS	6-1.5TLBLS	6-3-6TLBLS	6-3-6TLBLS
12	Pawl spring	6-0.75TLBPS	6-1.5TLBPS	6-3TLBPS	6-3TLBPS
13	Pawl	6-0.75TPAWL	6-1.5TPAWL	6-3TPAWL	6-6TPAWL
14	Snap ring	6-0.75TLBSR	6-1.5TLBSR	6-3TLBSR	6-3TLBSR
16	Free spring	6-0.75TLBFS	6-1.5TLBFS	6-3TLBFS	6-3TLBFS
17	Friction disk	6-0.75TFD	6-1.5TFD	6-3TFD	6-6TFD
19	Female thread grip	6-0.75TLBFTG	6-1.5TLBFTG	6-3TLBFTG	6-3TLBFTG
20	Brake cover assembly	6-0.75TLBBCA	6-1.5TLBBCA	6-3TLBBCA	6-3TLBBCA
23	Change over pawl	6-0.75TLBCOP	6-1.5TLBCOP	6-3TLBCOP	6-3TLBCOP
24	Spring seat	6-0.75TLBSS	6-1.5TLBSS	6-3TLBSS	6-3TLBSS
25	Change over spring	6-0.75TLBCOS	6-1.5TLBCOS	6-3TLBCOS	6-3TLBCOS
26	Bushing	6-0.75TLBB	6-1.5TLBB	6-3TLBB	6-3TLBB
28	Load chain				
29	Chain ring	6-0.75TLBCR	6-1.5TLBCR	6-3TLBCR	6-3TLBCR
30	Name plate	6-0.75TLBNP	6-1.5TLBNP	6-3TLBNP	6-3TLBNP
31	Top hook assembly	6-0.75TLBTHA	6-1.5TLBTHA	6-3TLBTHA	6-6TLBTHA
32	Top hook shaft	6-0.75TLBTHS	6-1.5TLBTHS	6-3TLBTHS	6-3TLBTHS
33	Bottom hook assembly	6-0.75TLBBHA	6-1.5TLBBHA	6-3TLBBHA	6-6TLBBHA
34	Chain pin	6-0.75TLBCP	6-1.5TLBCP	6-3TLBCP	6-3TLBCP
35	Hex nut	6-0.75TLBHN	6-1.5TLBHN	6-3TLBHN	6-3TLBHN
36	Lock washer	6-0.75TLBLW	6-1.5TLBLW	6-3TLBLW	6-3TLBLW
37	Hex nut	6-0.75TLBHNN	6-1.5TLBHNN	6-3TLBHNN	6-3TLBHNN
38	Lock washer	6-0.75TLBLW	6-1.5TLBLW	6-3TLBLW38	6-3TLBLW38
39	Screw	6-0.75TLBS	6-1.5TLBS	6-3TLBS	6-3TLBS
40	Castle nut	6-0.75TLBCN	6-1.5TLBCN	6-3TLBCN	6-3TLBCN
41	Split pin	6-0.75LBSP	6-1.5LBSP	6-3TLBSP	6-3TLBSP
42	Lock nut	6-0.75TLBLN	6-1.5TLBLN	6-3TLBLN	6-3TLBLN
43	Wire snap ring	6-0.75TWSR	6-1.5TWSR	6-3TWSR	6-3TWSR
44	Screw	6-0.75TLBSS	6-1.5TLBSS	6-3TLBSS44	6-3TLBSS44
45	Lock washer	6-0.75TLBLW	6-1.5TLBLW	6-3TLBLW45	6-3TLBLW45
46	Rivet	6-0.75TLBR	6-1.5TLBR	6-3TLBR	6-3TLBR
47	Snap ring	6-0.75TLBSR	6-1.5TLBSR	6-3TLBSR	6-3TLBSR
61	Safe clip assembly	6-0.75TSCA	6-1.5TSCA	6-3TSCA	6-6TSCA



SPARE PARTS

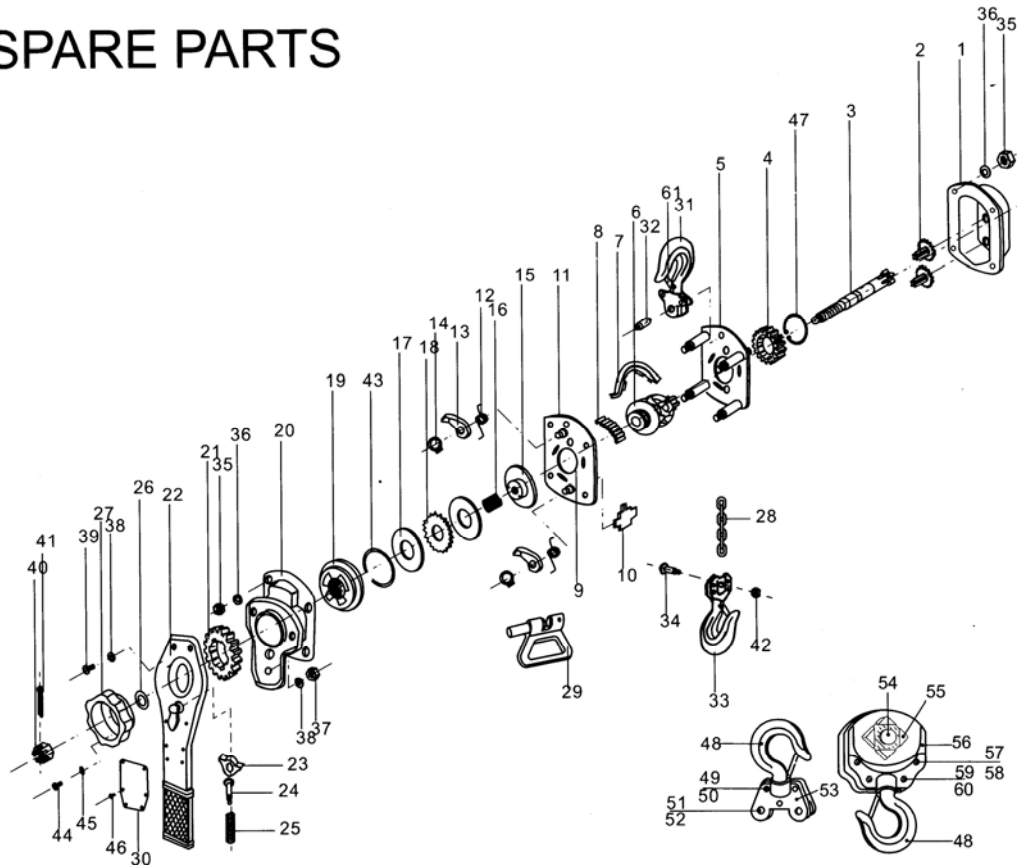

#	Description	#	Description	#	Description	#	Description	#	Description
1	Gear assembly	14	Snap ring	27	Hand wheel	40	Castle nut	53	6t top hook frame
2	Disk gear assy.	15	Disk hub	28	Load chain	41	Split pin	54	Move wheel pin
3	Drive shaft	16	Free spring	29	Chain ring	42	Lock nut	55	Move wheel
4	Splined gear	17	Friction disk	30	Name plate	43	Wire snap ring	56	6t bottom hook frame
5	Gear side plate assy.	18	Ratchet disk	31	Top hook assy.	44	Screw	57	Nut
6	Load sheave	19	Female thread grip	32	Top hook shaft	45	Lock washer	58	Screw
7	Guide plate	20	Brake cover assy.	33	Bottom hook assy.	46	Rivet	59	Nut
8	Roller	21	Change over gear	34	Chain pin	47	Snap ring	60	Screw
9	Bearing race	22	Lever handle assy.	35	Hex nut	48	6t hook	61	Safe clip assembly
10	Stripper	23	Change over pawl	36	Lock washer	49	Nut		
11	Lever side plate assy.	24	Spring seat	37	Hex nut	50	Screw		
12	Pawl spring	25	Change over spring	38	Lock washer	51	6t pin		
13	Pawl	26	Bushing	39	Screw	52	Nut		

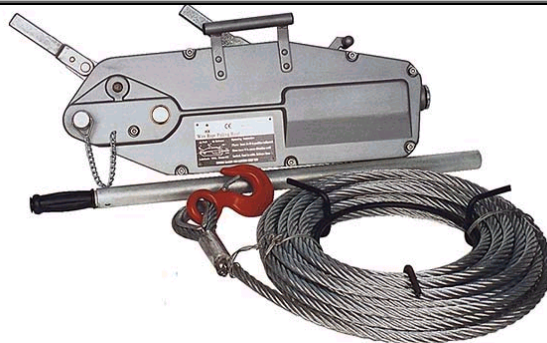

Wire Rope Winch – c/w wire and hook

Capacity lifting	Capacity pulling	Rope dia.	Weight Kg	Size	Drive step	c/w std wire length	Part Number
0.8 te	1.3 te	8 mm	6	428 x 64 x 235	1	20 m	WRW08T
1.6 te	2.6 te	11 mm	12	545 x 97 x 286	1	20 m	WRW16T
3.2 te	5.2 te	16 mm	23	660 x 116 x 350	2	10 m	WRW32T

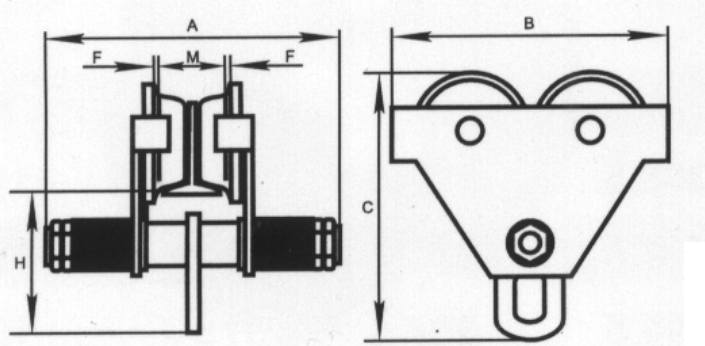

Trolley 619

Capacity	1-Beam Width	N.W./ KGS	A	B	C	H	Part Number
0.5 te	64-140	7	230	212	198.5	113	12TT619
1 te	64-140	12	254	255	231.5	128	01TT619
1.5 te	76-165	18	276	277	265	145	112T619
2 te	76-165	22	294	302	278	152	02TT619
3 te	76-203	30	344	344	338	186	03TT619
5 te	88-203	55	360	378	393	219	05TT619
10 te	125-203	93	403	455	490	275.5	010T619

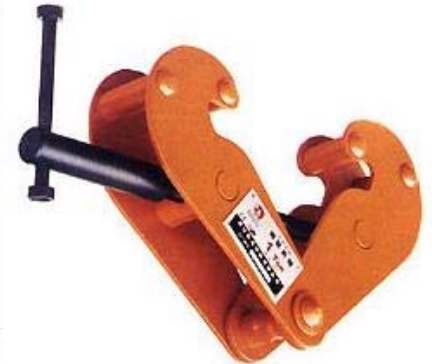
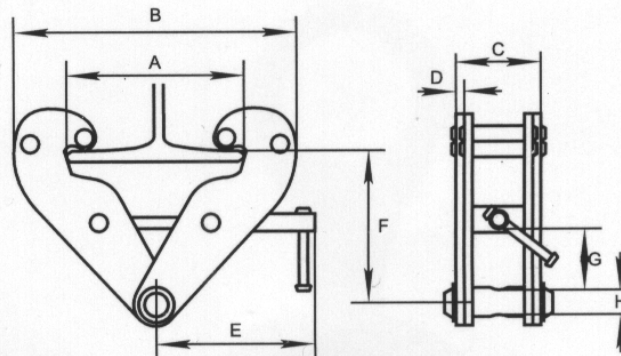

Beam Clamps

WLL Tonne	Adj. Beam Width	A Max	B		C	D	E	F		G	H	Part Number
			Min	Max				Min	Max			
1	75-220	260	180	360	64	5	215	102	155	25	22	0001TBC
2	75-220	260	180	360	74	6	215	102	155	25	22	0002TBC
3	80-320	354	235	490	103	8	260	140	225	45	24	0003TBC
5	80-320	354	235	490	110	10	260	140	225	45	28	0005TBC
10	90-320	365	320	505	120	12	280	170	235	50	40	0010TBC